



SEBO BALANCE A1

OWNER'S MANUAL

For Household Use Only

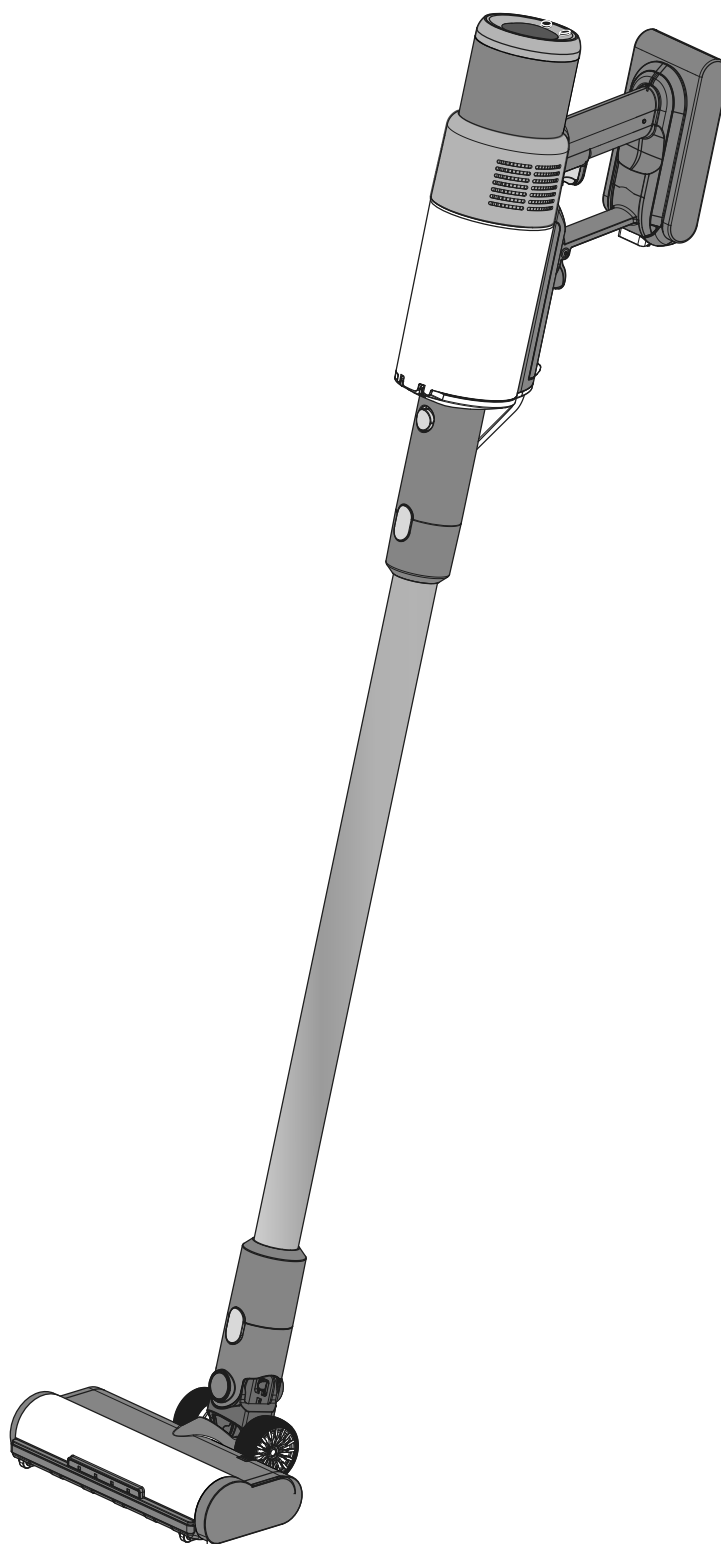

TABLE OF CONTENTS

Technical Details	2
How To Contact SEBO	2
Important General Safety Instructions.....	3
Important Battery Safety Instructions.....	4
SEBO BALANCE A1 Product Features.....	5
Identification of Parts	6
Assembly	7
Attach the Adapter	7
Attach the Battery	7
Charging the Battery.....	8
Assemble the Station.....	8
Operating Instructions	9
Starting the Machine.....	9
The Display and Power Control	9
Using the Tools and Accessories	10
Maintenance	11
Emptying the Dust Container.....	11
Cleaning out the Cyclone Unit.....	12
Changing the Motor Protection Filter	12
Changing the Micro Hygiene Filter.....	12
Changing the Brush Roller on the Power Brush	13
Changing the Brush Roller on the Mini Power Brush.....	13
Clog Removal	14
Clogs in the Suction Tube.....	14
Clogs in the Extension Hose	14
Clogs in the Dust Container Air Duct	14
Clogs in the Adapter Air Duct.....	14
Clogs in the Power Brush or Mini Power Brush Neck	14
Clogs in the Accessories	14
Trouble-Shooting Guide.....	15
BALANCE A1 Schematic and Part Numbers	16

TECHNICAL DETAILS

Nominal voltage AKKU	25,9 V DC
Isolation class	Protective low voltage III
Suction Unit:	
Dust bin volume	1 gal. (.38 liter)
Typical working weight	5.1 lbs. (2,3 kg)
Length	16.1 in. (410 mm)
Width	3.94 in. (100 mm)
Height	8.86 in. (225 mm)

HOW TO CONTACT SEBO

To contact SEBO in the United States of America:

SEBO America, LLC
Telephone: (800) 334-6614
Fax: (303) 792-9196
Website: www.sebo.us

For warranty coverage details and to register your SEBO BALANCE A1, go to www.sebo.us

To contact SEBO in Canada:

SEBO Canada
Telephone: (877) 258-2005
Fax: (800) 270-4807
Website: www.sebocanada.ca

For warranty coverage details and to register your SEBO BALANCE A1, go to www.sebocanada.ca

IMPORTANT GENERAL SAFETY INSTRUCTIONS



READ ALL INSTRUCTIONS BEFORE USING THIS MACHINE

Failure to follow the warnings and instructions may result in electric shock, fire and/or serious injury. When using an electrical appliance, basic precautions must always be followed.

The SEBO BALANCE A1 uses rechargeable lithium-ion batteries. It can only be operated with original specification SEBO batteries AKKU A1 and can only be charged with the SEBO BALANCE charger BZ019-310050-AU. Refer to page 4 for Battery Precautions.

SAVE THESE INSTRUCTIONS.

WARNING: General Precautions -

To reduce the risk of fire, electric shock, or injury:

1. Use only as described in this manual. Use only manufacturer-recommended attachments.
2. Never stand a machine without a battery fitted on the base of the handle, as there is a danger of tipping the machine, and the battery contacts may be damaged. Place machines without a battery on their side on a flat surface.
3. Do not use near small children or pets. Do not allow to be used as a toy. Use of this product by children should always be supervised by an adult.
4. Do not use on people or animals.
5. Do not use outdoors or on wet surfaces. Keep out of direct sunlight. Do not store outdoors.
6. If vacuum is not working as it should, has been dropped, damaged, left outdoors, or dropped into water, take it to a SEBO service center.
7. Turn off the vacuum cleaner and remove battery before undertaking any maintenance.
8. Carry the vacuum over steps and sills. Avoid running vacuum over cables on the floor.
9. When operating the vacuum, always use the handle.
10. Do not put any object into vacuum openings. Do not use machine with any openings blocked. Keep openings free of lint, hair, and anything that may reduce air flow.
11. Do not wash the filters.
12. Do not use vacuum without filters in place.
13. Do not remove any screws from vacuum.
14. Do not vacuum up anything that is burning or smoking, such as cigarettes, matches, or hot ashes.
15. Use extra care when cleaning on stairs.
16. Do not use machine to vacuum up flammable or combustible liquids such as gasoline or use in areas where they may be present.
17. Machines can cause a fire when operated near flammable vapors or materials. Do not operate this vacuum near flammable fluids, dust or vapors.
18. Do not use vacuum as a step.
19. Keep hair, loose clothing, fingers, and all parts of body away from vacuum openings and moving parts. Do not touch the brush roller with fingers or other body parts when battery is installed or vacuum is working as this can cause risk of injury.
20. Do not place the power brush over rug or carpet edges.
21. The connector pins on the base of the handle where the battery connects should never be in contact with metallic objects and must not be exposed to any fluids or contamination. Care must be taken not to damage the connector pins in any way.
22. Store the vacuum in a dry place at room temperature.
23. Use only original SEBO replacement parts.
24. All servicing should be performed by a SEBO service representative.

Refer to Battery Precautions on Page 4 for warning information in addition to these General Precautions listed on this page.

IMPORTANT BATTERY SAFETY INSTRUCTIONS



READ ALL INSTRUCTIONS BEFORE USING THIS MACHINE

Failure to follow the warnings and instructions may result in electric shock, fire and/or serious injury. When using an electrical appliance, basic precautions must always be followed.

The SEBO BALANCE A1 uses rechargeable lithium-ion batteries. It can only be operated with original specification SEBO batteries AKKU A1 and can only be charged with the SEBO BALANCE charger BZ019-310050-AU.

SAVE THESE INSTRUCTIONS.

WARNING: Battery Precautions - To reduce the risk of fire, electric shock, or injury:

1. Close attention is necessary when used by or near children, pets or plants.
2. Do not use with damaged cord or charger. If appliance is not working as it should, has been dropped, damaged, left outdoors, or dropped into water, return it to a service center.
3. Do not pull or carry charger by cord, use cord as a handle, close a door on cord, or pull cord around sharp edges or corners. Do not run appliance over cord. Keep cord away from heated surfaces.
4. Do not unplug charger by pulling on cord. To unplug, grasp the plug, not the cord.
5. Prevent unintentional starting, which may cause accidents, by ensuring the switch is in the off-position before connecting to battery pack, picking up or carrying the appliance. Do not carry the appliance with your finger on the switch.
6. Disconnect the battery pack from the appliance before making any adjustments, changing accessories, or storing appliance. Such preventive safety measures reduce the risk of starting the appliance accidentally.
7. Recharge only with the charger specified by the manufacturer. A charger that is suitable for one type of battery pack may create a risk of fire when used with another battery pack.
8. Use appliances only with specifically designated battery packs. Use of any other battery packs may create a risk of injury and fire.
9. When battery pack is not in use, keep it away from other metal objects, like paper clips, coins, keys, nails, screws or other small metal objects, that can make a connection from one terminal to another. Shorting the battery terminals together may cause burns or a fire.
10. Liquid ejected from a damaged battery may cause irritation or burns. Avoid contact with the liquid. If contact occurs, flush with water. If liquid contacts eyes, additionally, seek medical help.
11. Do not use a battery pack or appliance that is damaged or modified. Damaged or modified batteries may exhibit unpredictable behavior resulting in fire, explosion or risk of injury.
12. Do not expose a battery pack or appliance to fire or excessive temperature. Exposure to fire or temperature above 130°C/266°F may cause explosion
13. Follow all charging instructions and do not charge the battery pack or appliance outside of the temperature range specified in the instructions. Charging improperly or at temperatures outside of the specified range may damage the battery and increase the risk of fire.
14. Have servicing performed by a qualified repair person using only identical replacement parts. This will ensure that the safety of the product is maintained.
15. Do not modify or attempt to repair the appliance or the battery pack except as indicated in the instructions for use and care.
16. The appliance should be stored, used and charged at a temperature range 4.4°C~40°C/40°F~104°F.
17. Always turn off this appliance before connecting or disconnecting motorized nozzle.
18. The battery has a management system (charge-termination circuit) that will prevent the battery from over-charging or affect the battery life. However, it is a common battery safety practice to not leave the battery plugged into the charger after the battery is fully charged.
19. Do not use non-rechargeable batteries of any kind in your SEBO BALANCE.
20. Check the battery and machine for irregularities and damage prior to each use.
21. Do not handle battery or battery charger with wet hands.
22. Never expose a battery to mechanical stress. Do not drop or dismantle it. Do not expose to heat or leave in direct sunlight.

SEBO BALANCE A1 PRODUCT FEATURES

Designed for All Floor Surfaces.

The new SEBO BALANCE A1 heralds a new era: A cordless, battery-powered vacuum cleaner for all floors and surfaces that combines SEBO's decades of experience with state-of-the-art technology. Optimized by German engineering, the SEBO BALANCE A1 also offers a comprehensive package of useful tools and accessories. Ergonomic, lightweight and versatile, it is the ideal cleaning tool for everyday challenges.

Lightweight – Weighing just five pounds, the SEBO BALANCE A1 is a real lightweight. Whether on floors, stairs, or hard-to-reach areas, the ultra-lightweight design ensures effortless cleaning and maximum convenience in every application. Cleaning has never been so easy!

Powerful Suction – The battery, together with the digital brushless motor with more than 100,000 rpm, ensures efficient and effective cleaning. There are three power-level options.

Battery Life – The battery can operate uninterrupted for 48 minutes at Power-level 1 or up to 20 minutes at Power-level 3 – enough to thoroughly clean most homes with maximum flexibility and efficiency.

Quiet Operation – With a noise level of just 69 dB at Power-level 1, the SEBO BALANCE A1 operates so quietly that it hardly disturbs your surroundings – ideal for households with children, pets, or sensitive ears.

Soft-start Switch – The vacuum's gradual power-up capability extends motor life.

Intuitive Handling with LED Display –

The LED display shows the battery charge level precisely as a percentage and enables easy adjustment of the power level using the integrated buttons. The selected level is clearly displayed in a bar graph.



High-quality Microfiltration – The SEBO BALANCE A1 is equipped with a multi-stage filtration system to ensure maximum air purification. The first stage is the main cyclone that acts as a coarse separator. The second stage is equipped with six downstream mini-cyclones that filter out fine particles. Finally, the air passes through the third and fourth stages of the motor protection filter and the micro-hygiene filter, which extract the finest particles. The purified air is then released back into the room cleaner than before.

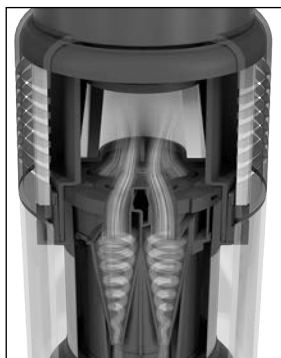

Powerful Electric Brush – If aggressive surface agitation is needed, the A1 offers an electric brush with an LED headlamp, shock protection, and self-cleaning anti-hair-wrap technology that effectively removes dirt and hair.

Automatic Shut-off – If an obstruction jams the brush roller or a clog develops, the machine automatically shuts off to prevent overheating and damage.



Tools and Accessories included with the Balance A1 – The vacuum comes standard with a power brush, mini power brush, crevice nozzle, dusting brush, dusting & upholstery nozzle, extension hose and two brush rollers – one for multi surfaces and one for hard floors. Also included is a battery and charger, a charging and accessory stand and a wall-mount charging station.

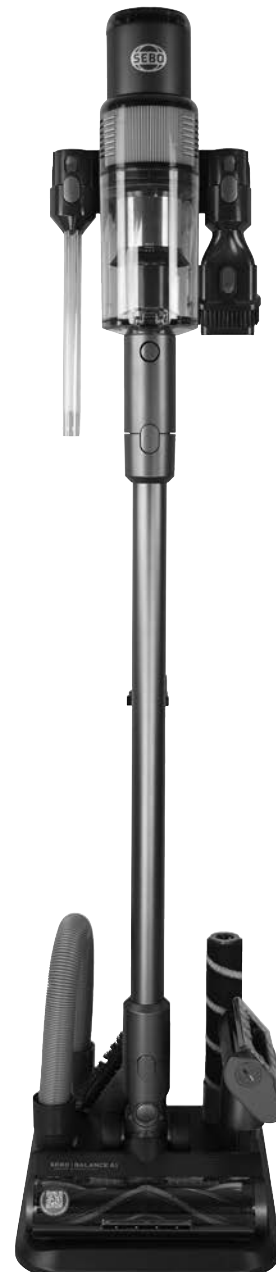

IDENTIFICATION OF PARTS

- | | |
|----------------------------------|----------------------------|
| 1. Suction unit | 13. On/Off switch |
| 2. Dust container | 14. Battery release button |
| 3. Adapter release button | 15. Battery charger |
| 4. Adapter | |
| 5. Suction tube release button | |
| 6. Suction tube | |
| 7. Power brush release button | |
| 8. Power brush | |
| 9. Display and power control | |
| 10. Handle | |
| 11. Battery | |
| 12. Dust container release lever | |

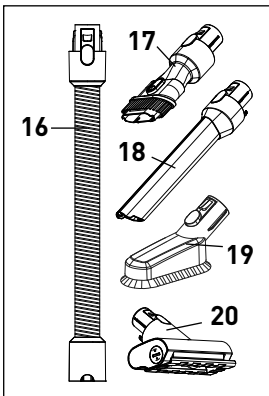

Attachments

- 8. Power brush
- 16. Extension hose
- 17. Dusting & upholstery nozzle
- 18. Crevice nozzle
- 19. Dusting brush
- 20. Mini power brush

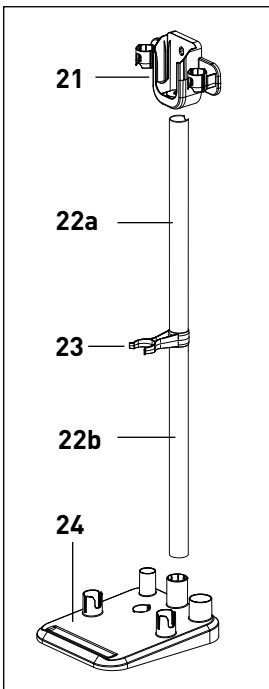

BALANCE A1 Station

- 21. Wall mount
- 22a. Support tube
- 22b. Support tube
- 23. Suction tube support clamp
- 24. Base

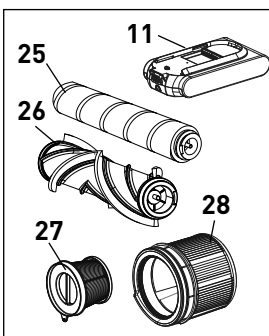

Brush rollers, filters, battery

- 11. Battery
- 25. MicroCare hard floor brush roller
- 26. MultiCare universal brush roller
- 27. Motor protection filter
- 28. Micro hygiene filter

Note: Two Motor protection filters are included with your BALANCE A1. One is installed and one is in the packaging.

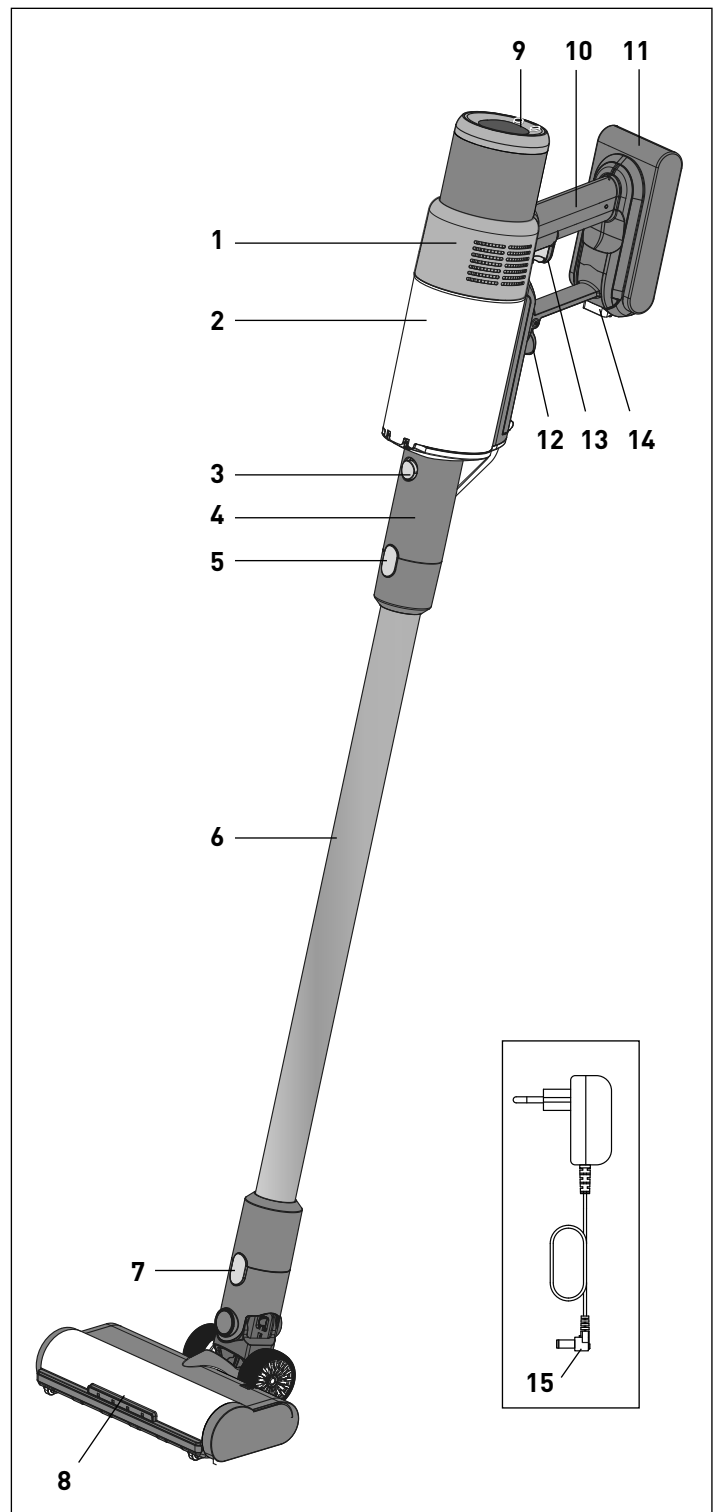

ASSEMBLY

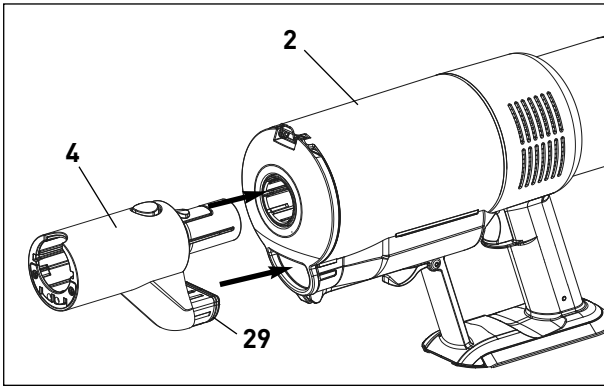

Figure 1

Step 1 - Attach the Adapter - Figure 1 - Fit the adapter (4) into the center of the dust container (2), with the air channel (29) lined up with the duct under the dust container. Slide the adapter in until it clicks into place.

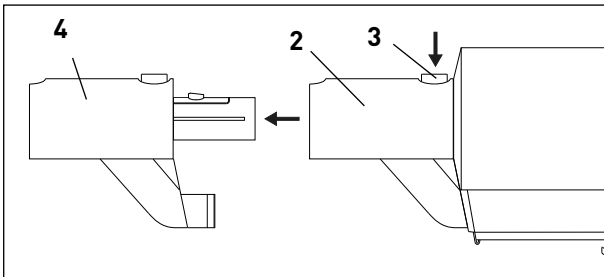

Figure 2

To release the adapter (figure 2), press the adapter release button (3) and pull adapter out.

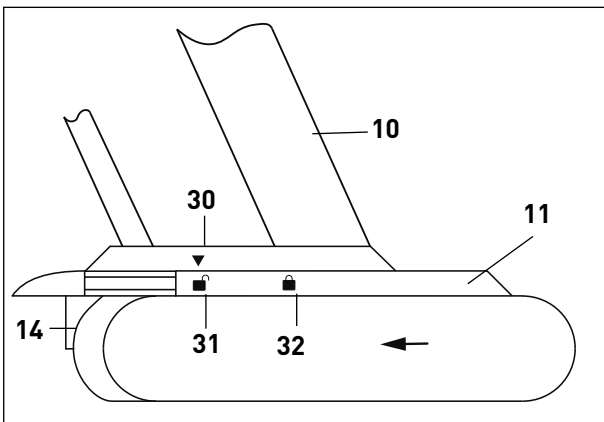

Figure 3

Step 2 - Attach the Battery - Figures 3 & 4 - To attach the battery (11) onto the bottom of the handle (10), align the arrow (30) on the base of the handle with the open lock symbol (31) on the battery (figure 3). The battery will then be lined up between the grooves on the handle base. Slide the battery toward the front of the handle until the arrow on the base of the handle (30) is lined up with the locked symbol (32) on the battery and it clicks into place (figure 4).

To remove the battery, push the battery release button (14) and slide the battery toward the back of the handle until the arrow (30) on the base of the handle lines up with the open lock symbol (31) on the battery. Lift battery off.

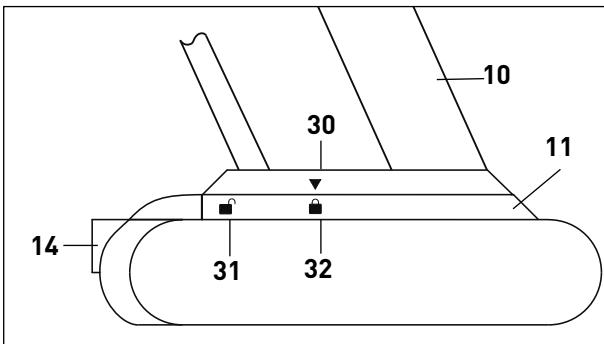

Figure 4

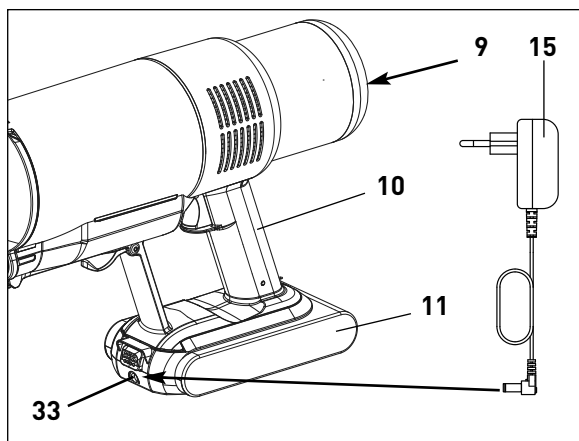

Figure 4

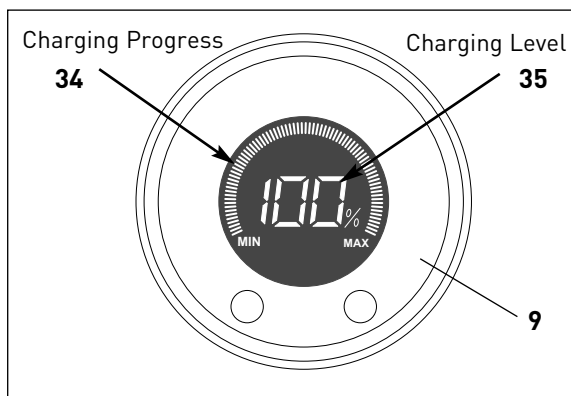

Figure 5

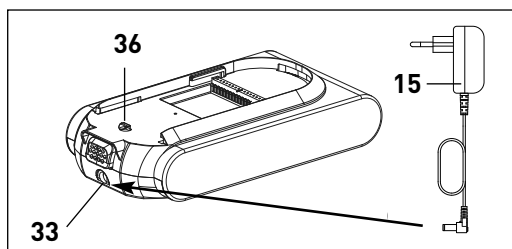
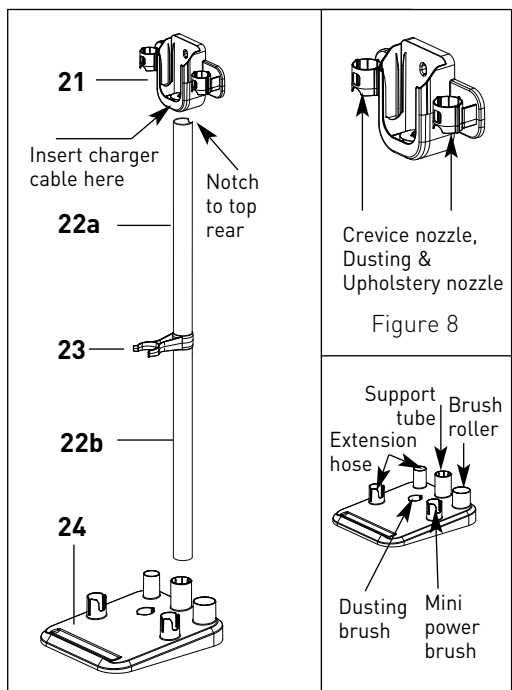

Figure 6



Step 3 - Charge the Battery - Figures 4, 5 & 6 - The battery (11) must be completely charged before use. For safety and to extend the life of the battery, unplug the charger (15) from the outlet once the battery is fully charged (See page 4, #18). The battery can be charged either connected to the handle or separately.

The charging socket (33) is located on the front of the battery (figure 4). If you are using the station or the wall mount (41), position near an outlet for charging convenience.

After the first charge, re-charging levels between 30% and 80% are ideal.

Charging while the battery is connected to the handle - Figures 4 & 5 - If charging not in the wall mount or station, place the machine on a level heat-proof surface where it will not fall over. The charging progress (34) is shown in red and increases continuously with the charging level (35) of the battery. The number in the center of the display (35) shows the percentage of usable power. When the battery is fully charged, both the charging progress bars and the percentage symbol turn green and 100% is displayed.

Charging battery separated from the machine - Figure 6 - Place battery on a stable, heat-proof surface and connect the cable of the charger (15) to the charging socket (33). Charging is indicated by a flashing blue LED light (36) on top of the battery. The charging process has been completed when the light turns off.

NOTE: Never expose the battery to mechanical stress. Do not drop or dismantle it. **Do not expose to heat or leave in direct sunlight.** Check the battery and machine for irregularities and damage prior to use. Never use a damaged machine. Use only the original SEBO A1 charger or genuine SEBO replacements purchased from an authorized SEBO dealer. Charging with non-approved devices can damage the battery, can cause a fire and voids the warranty.

Damaged or faulty batteries must not be used and must be replaced immediately.

Step 4 - Assemble the Station - Figures 7, 8 & 9 - The BALANCE A1 Station is for housing the machine and all accessories (see assembled station with accessories attached on page 5). The base (24), the two-piece support tube (22a and 22b) and the Wall Mount (12). can simply be fitted together. Insert the fluted end of the top tube (22a) into the bottom tube (22b). The top tube has the suction tube connector (23) mounted to it. Please ensure the U-shaped cutout in one of the tube sections is placed at the top so it can connect to the wall mount (figure 7). If the station is not desired, the wall mount can be affixed to a wall with screws.

Install the station near an outlet so that battery charging is possible when a vacuum cleaner is fitted. The charging cable plugs into the lower left part of the wall mount. As soon as the battery is placed in the holder, charging will begin. When the machine indicates the charging process is finished, the charger should be turned off.

The wall mount (21) has storage points (figure 8) for the crevice nozzle (18) and the dusting & upholstery nozzle (17). Insert the tool from the bottom until the button snaps in place.

The mini power brush (20), the dusting brush (19), the extension hose (16) and a brush roller (25 or 26) can be stored on the base (figure 9).

While in the stand, the power brush (8), adapter (4) and the suction tube (6) should stay connected to the suction unit (1). However, If the suction unit and adapter are removed, the connector (23) is a support clamp that will securely hold the suction tube (6).

OPERATING INSTRUCTIONS

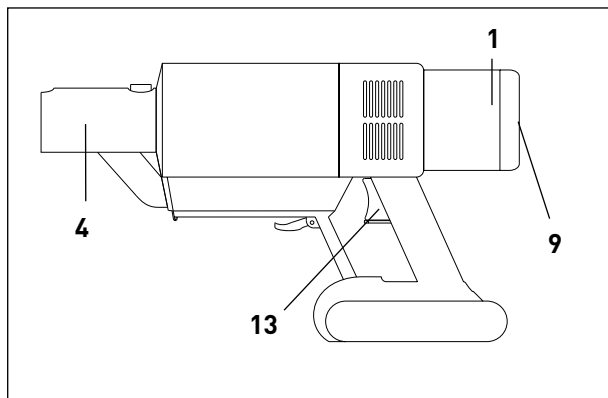

Figure 10

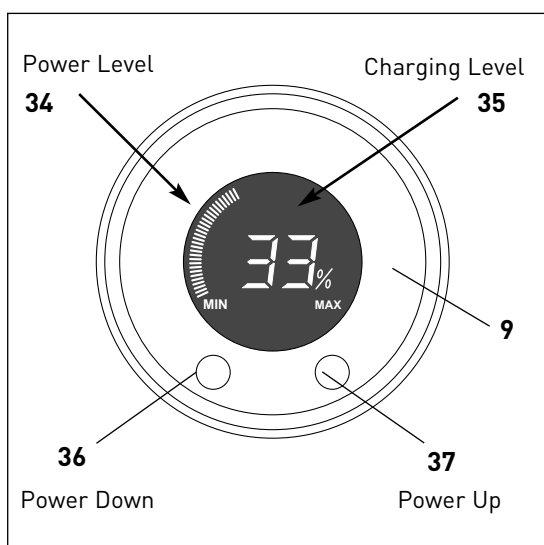

Figure 11

Starting The Machine - Figure 10 - After connecting the adapter and charging the battery (see pages 7 and 8), the machine is ready for use. The on/off switch (13) turns the machine on. A short press of the switch is sufficient, you do not need to press it continuously.

Display and Power Control - Figure 11 - The battery level display and power control buttons are located at the rear of the Suction Unit (figure 10).

The three power levels of the machine can be selected with power down (36) and power up buttons (37). The chosen power level is shown by the bar graph (34) during operation. Each press of the up or down button moves the power to the next level.

- First third - Power level 1 (shown on illustration)
- First and second third - Power level 2
- All segments - Power level 3

The battery can operate uninterrupted for 48 minutes at Power level 1 or up to 20 minutes at Power level 3 – enough to thoroughly clean most homes with maximum flexibility and efficiency.

If you accidentally turn the machine off, it will restart at the last power level used if the machine is turned on within approximately 10 seconds.

NOTE: Never stand a machine without a battery fitted on the base of the handle. There is a danger of tipping and the battery contacts may be damaged. Place machines without a battery on their side on a flat surface, or place on the BALANCE A1 Station.



WARNING!

The quality, condition, coating, texture, age and manufacturing technique of all floor surfaces vary. Therefore, vacuums with rotating brushes, including your SEBO, may damage some floor coverings or surfaces. Some types of high-gloss hardwood floors, cushion vinyl, berber carpets, long shag, and delicate or hand-woven carpets are particularly vulnerable to damage by rotating brushes. When possible, consult the materials supplied by your floor's manufacturer for information on proper upkeep and cleaning. **To ensure that your new SEBO vacuum cleaner is compatible with your floor, please test the vacuum cleaner on each type of flooring surface in a small inconspicuous area to determine if any damage occurs. If damage occurs, stop using the vacuum cleaner immediately!**

The universal MultiCare brush roller on your SEBO vacuum is appropriate for most types of floor surfaces. However, the MicroCare soft-bristle brush roller, designed for use on sensitive looped-pile carpets and/or hard floors, is included with your A1. As with the universal brush roller, you should test the machine using the MicroCare soft-bristle brush roller in an inconspicuous area prior to widespread use. The soft-bristle roller will wear more quickly than the universal brush roller, so it will need to be replaced more often.

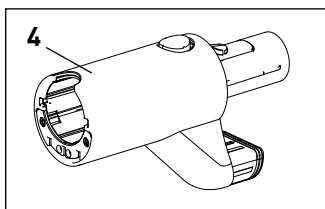

Using the Tools & Accessories

Adapter (4) - The adapter connects the suction unit to the accessories and attachments.

Suction Tube (6) - The Power brush, the Mini power brush, and the accessories (crevice nozzle, both dusting brushes) can be fitted to the suction tube.

Extension Hose (16) - The Power brush, the Mini power brush, and the accessories (crevice nozzle, both dusting brushes) can be fitted to the extension hose.

Power Brush (8) - The power brush uses the MicroCare or MultiCare brush roller. Use for large floor areas that require brush roller action.

Mini Power Brush (20) - The Mini Power Brush is for smaller floor areas or carpeted stairs that require brush roller action.

Dusting & Upholstery Nozzle (17) - This two-in-one nozzle can be use as an upholstery nozzle, or by pushing the bristles forward, as a dusting brush. To move the bristles, push the release button (38) and slide the bristles up or down.

Crevice Nozzle (18) - With its integrated LED light and slim shape, the Crevice Nozzle enables precise cleaning in dark, narrow, hard-to-reach areas.

Dusting Brush (19) - The Dusting Brush gently removes dust and debris from surfaces such as wooden stairs and furniture.

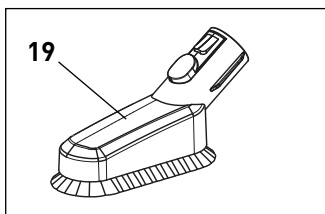
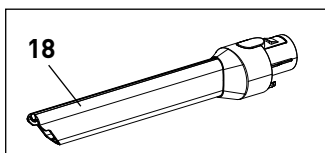
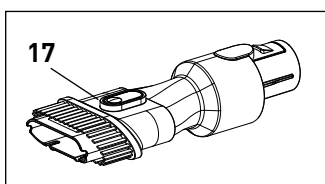
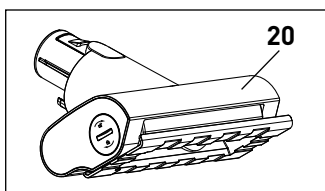
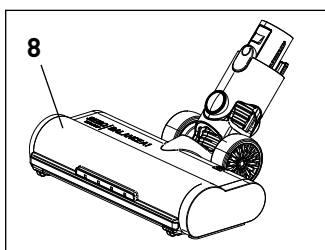
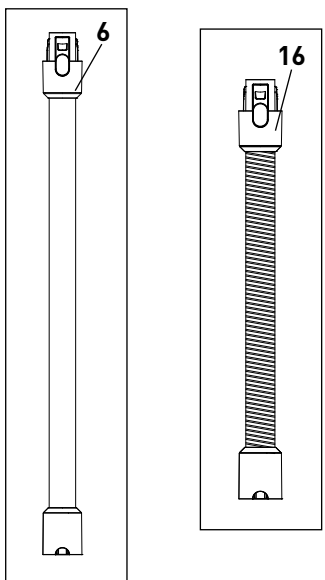

VACUUM MAINTENANCE



Always disconnect battery from machine before any maintenance!

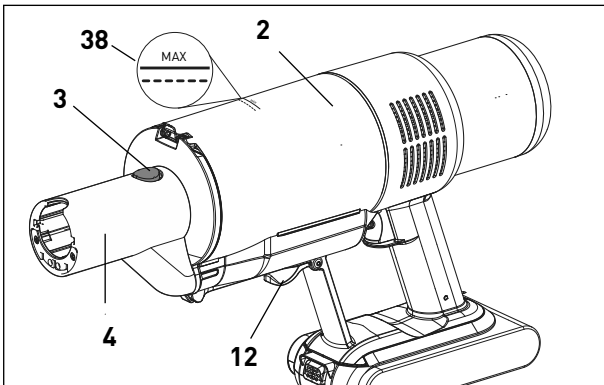

Figure 12

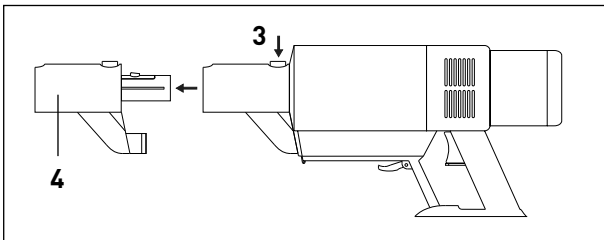

Figure 13

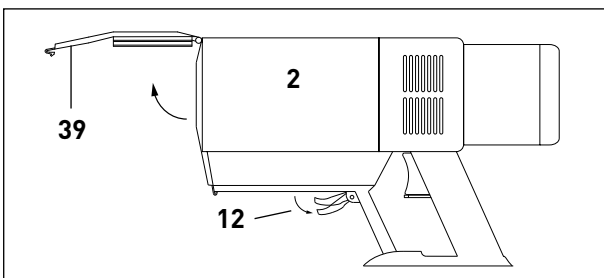

Figure 14

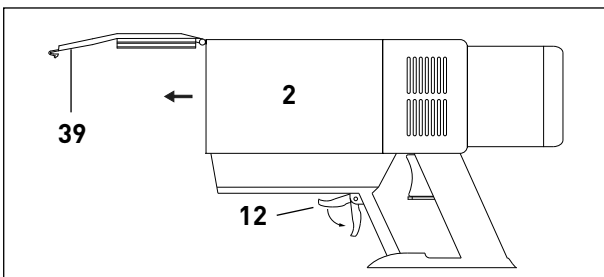

Figure 15

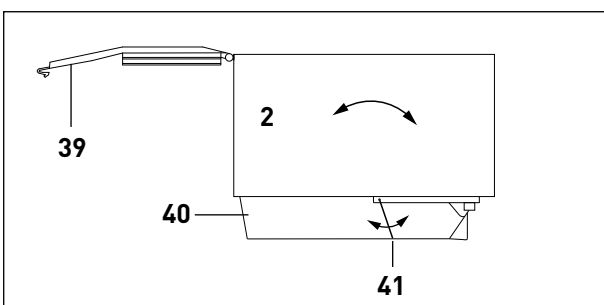

Figure 16

Emptying the Dust Container - Figures 12-16 - The dust container (4) must be emptied when the "MAX" level (38) is reached (figure 12).

Disconnect the battery and remove all accessories and the adapter (4) by pressing the adapter release button (#3 figure 13). Have a suitable container ready to receive the contents of the dust container.

Hold the dust container over trash receptacle. Pull the dust container release lever halfway (#12 figure 14). **The dust container lid (39) is spring loaded and will pop open.** Contents can then be emptied. For more comprehensive cleaning, the dust container can be fully removed by pulling the lever (#12 figure 15) all the way down. Once the dust container is fully removed from the suction unit, it can be cleaned with warm water and mild detergent. Rinse thoroughly and air dry for at least 24 hours before use.

There is a non-return flap (41) in the air duct (40) on the bottom of the dust container (figure 16). Check this flap for free movement every time the dust container is emptied. It should move freely when the dust container is shaken back and forth. If this flap is blocked by debris, the air path will be obstructed resulting in poor suction.

To replace the dust container, line it up and snap it in place. If it is not seated correctly, the lid will not close properly.



Always disconnect battery from machine before any maintenance!

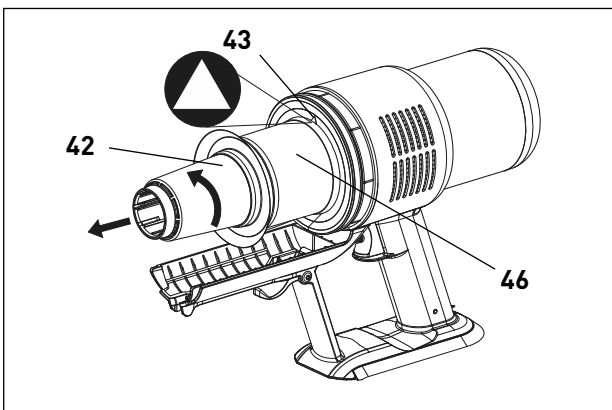

Figure 17

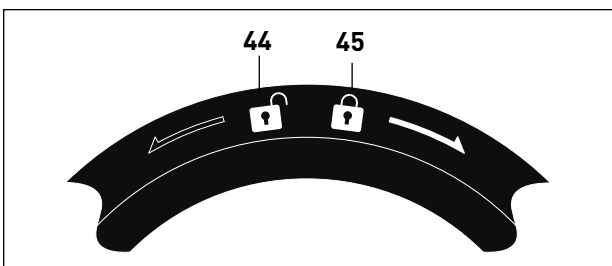

Figure 18

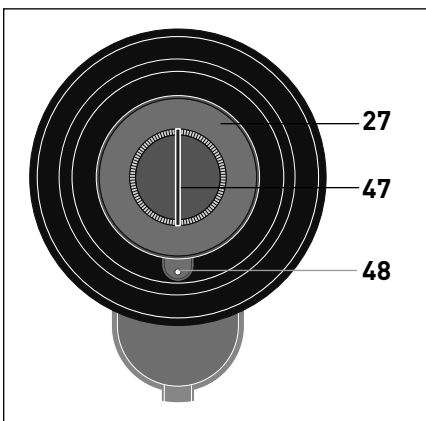

Figure 19

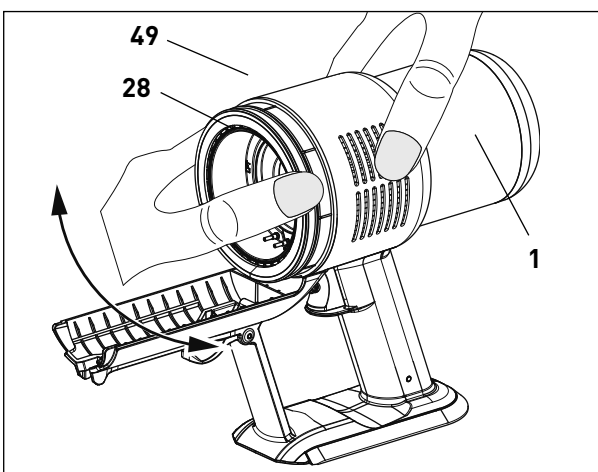

Figure 20

Cleaning out the Cyclone Unit - Figures 13-18 - Dust can accumulate in the cyclone unit (42). To remove the cyclone unit for cleaning, remove the adapter and dust bin (figures 13-16). Unlock the cyclone unit by gripping the front plastic cone and turning counterclockwise until the arrow (43) aligns with the open lock symbol (44) on the housing (figures 17 & 18).

Use a soft microfiber cloth to clean, being careful not to damage the metal foil collar (46). The six intake holes can be blown out with an air compressor, vacuumed out with another vacuum cleaner, or gently cleaned with pipe cleaners. **Do not wash! The cyclone unit has electrical connectors.**

The Suction Unit cannot be further dismantled. Any attempts to do so will cause irreversible damage and invalidate the warranty!

To re-install the cyclone unit, align the arrow (43) with the open lock symbol (44) on the machine body. Turn clockwise to align the arrow (43) with the locked symbol (45).

Changing the Motor Protection Filter - Figures 13-19 - To remove the motor protection filter (27), remove the adapter and dust bin (figures 13-16). Remove the cyclone unit (figures 17 & 18). The filter can be simply pulled out with the handle (#47 figure 19). When inserting the new filter, line the notch (48) on the filter with the indentation on the filter housing.

To re-install the cyclone unit, align the arrow (43) with the open lock symbol (44) on the machine body. Turn clockwise to align the arrow (43) with the locked symbol (45).

Changing the Micro Hygiene Filter - Figures 13-17, 20 - To remove the micro hygiene filter (28), remove the adapter and dust bin (figures 13-16). Remove the cyclone unit (figures 17 & 18).

Hold the suction unit (1) firmly and rock the rim of the micro-hygiene filter housing (49) back and forth while pulling (figure 20). Replace filter with open notch to the bottom.

To re-install the cyclone unit, align the arrow (43) with the open lock symbol (44) on the machine body. Turn clockwise to align the arrow (43) with the locked symbol (45).

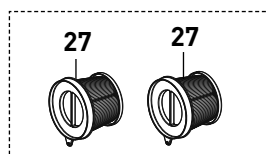

Part #8850AM - sold as a set of 2 Motor protection filters (27)

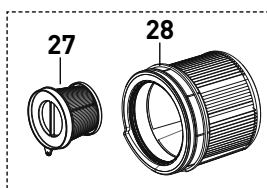

Part #8851AM - sold as a set of 1 Motor protection filter (27) and 1 Micro hygiene filter (28)



Always disconnect battery from machine before any maintenance!

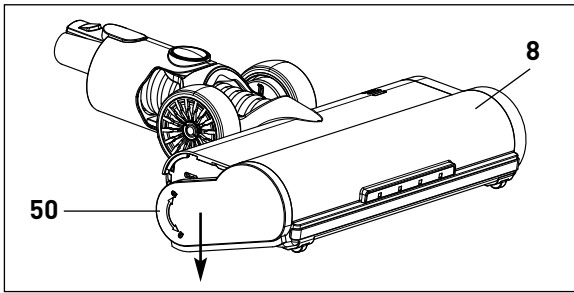

Figure 21

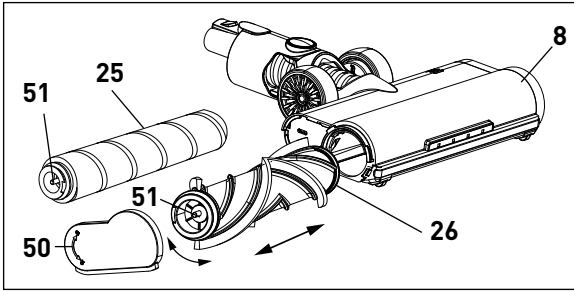

Figure 22

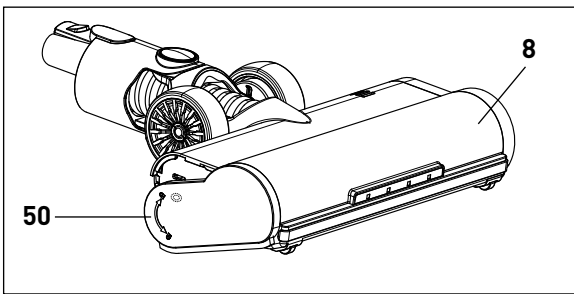

Figure 23

Changing the Brush Roller on the Power Brush - Figures 21-23

Turn the end cover (50) on the right-hand side of the Power Brush (8) downward (counterclockwise) to unlock and then remove the end cover (figure 21). Pull the brush out (figure 22) and remove any hair or string.

To insert the brush roller, insert the notched end first, turning it until it is fully seated and the brush end is even with the edge of the housing.

Fit the end cover over the spindle (51) of the brush roller with the rear of the end cover lower than the base of the power brush (figure 23). Rotate end cover upward to the locked position. NOTE: If the brush roller is inserted incorrectly, the end cover will not close. Do not force it, rotate the brush until it is seated.

Note: The brush rollers for the Power Brush and the Mini Power Brush can be washed with end covers removed. They must be air dried standing on end for at least 24 hours before use. Brushes should be replaced regularly for optimal performance.

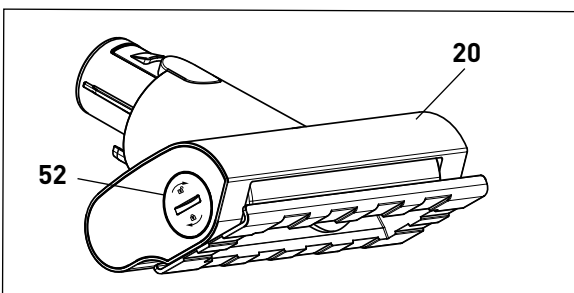

Figure 24

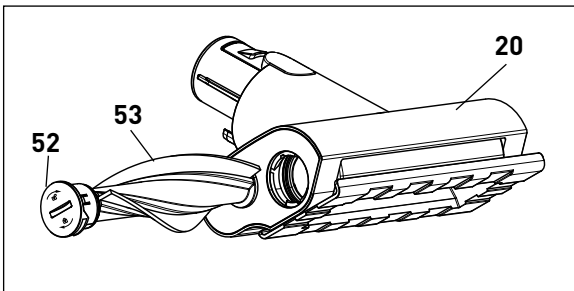

Figure 25

Changing the Brush Roller on the Mini Power Brush - Figures 24 & 25

Unlock the right-hand cover (52) with a coin (or something similar) and hold the brush roller bristles to push the brush roller out with the end cover attached. Remove the end cover (52) from the brush roller (53) and remove any hair or strings.

Re-insert the brush roller in reverse order and secure the cover (52) by turning it clockwise with a coin to the locked position. If the cover will not fit flush, rotate the brush roller.

CLOG REMOVAL



Always disconnect battery from machine before any maintenance!

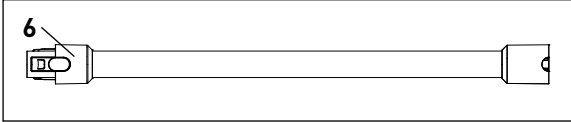

Figure 26

Clogs in the Suction Tube - Figure 26

Remove the suction tube (6) from the machine. A straight wire can be inserted into the tube to push out the clog.

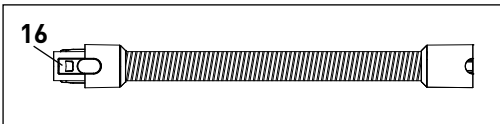

Figure 27

Clogs in the Extension Hose - Figure 27

Blockages in the hose can be cleared by removing the attachment hose (16) from the machine. A straight wire can be inserted into the hose to push out the clog. Take care not to puncture the hose with the wire.

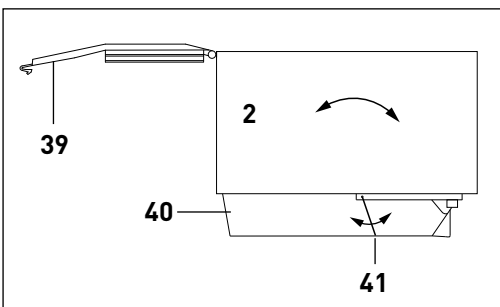

Figure 28

Clogs in the Dust Container Air Duct - Figure 28

Remove the Dust Container (see page 11). There is a non-return flap (41) in the air duct (40) on the bottom of the dust container (figure 16). Check this flap for free movement. It should move freely when the dust container is shaken back and forth. If this flap is blocked by debris, the air path will be obstructed resulting in poor suction, and should be cleaned out.

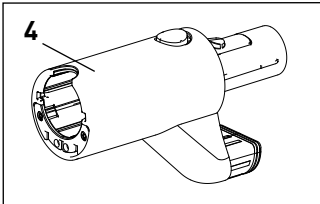

Figure 29

Clogs in the Adapter Air Duct - Figure 29

Remove the adapter by pressing the adapter release button and pulling it out of the suction unit. If the suction duct (54) has debris, clean out the pathway.

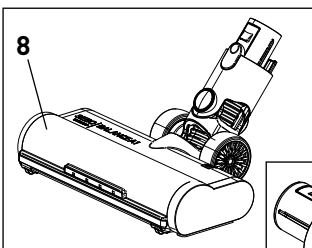

Figure 30

Clogs in the Power Brush or Mini Power Brush Neck - Figures 30 & 31

Remove the brush from the suction tube by pressing the release button and pulling it out. Clogs in the neck of the power brush or the mini power brush can be removed by pulling the debris out of the neck. If the clog is further down the channel, remove the brush roller (see page 13) to access the clog.

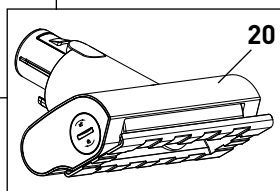

Figure 31

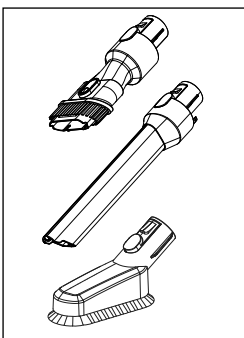

Figure 32

Clogs in the Accessories - Figure 32

Remove the accessory from the machine. Clogs in the neck or head of the accessory can be removed by pulling the debris out of the neck, or from the underside of the head.

TROUBLE-SHOOTING GUIDE



Always disconnect battery from machine before any maintenance!

PROBLEM	REASON	SOLUTION
Vacuum cleaner does not work	1. Battery not connected correctly.	1. Remove battery and re-attach. See pg. 7.
	2. Not enough battery charge.	2. Fully charge battery before use.
	3. Motor shuts off automatically due to high battery temperature.	3. Restart after the machine has cooled down.
	4. Clog in the air path	4. Remove debris from the air duct or air flap. See pg. 14.
Poor suction	1. Dust container is full or the filters are clogged with fine dust.	1. Clean out the dust container and replace the filter set. See pg. 11.
	2. Clog in accessory.	2. See Clog Removal on pg. 14.
Unusual motor sounds	1. The main air path is clogged.	1. Check the air path from the accessory, through the suction tube, the adapter, dust container and filters. See pgs. 11 and 14.
Flashing percent symbol	1. Charging is required.	1. Recharge the battery. See pg. 8.
Machine shuts off Display shows E1	1. Low operating voltage.	1. Recharge the battery. See pg. 8.
Machine shuts off Display shows E2	1. Brush roller blocked.	1. Clean the power brush and brush roller. See pg. 14.
Machine shuts off Display shows E3	1. Dust container full/filters clogged.	1. Empty dust container, replace filters if needed. See pgs. 11 and 12.
Machine shuts off Display shows E4	1. Motor protection filter missing	1. Replace or re-install the motor protection filter. See pg. 12.
Machine shuts off Display shows E5	1. Electrical malfunction of power brush.	1. Contact SEB0 service for support.
Machine shuts off Display shows E6	1. Electrical malfunction of the suction unit.	1. Contact SEB0 service for support.
Machine shuts off Display shows E7	1. Battery not charged.	1. Contact SEB0 service for support.
Machine shuts off Display shows E8	1. High temperature protection activated.	1. Contact SEB0 service for support.
Machine shuts off Display shows E9	1. Suction unit motor current too high.	1. Contact SEB0 service for support.

BALANCE A1 SCHEMATIC AND PARTS LIST

#95010AM BALANCE A1 GRAY
#95011AM BALANCE A1 BLUE
#95012AM BALANCE A1 MAGENTA

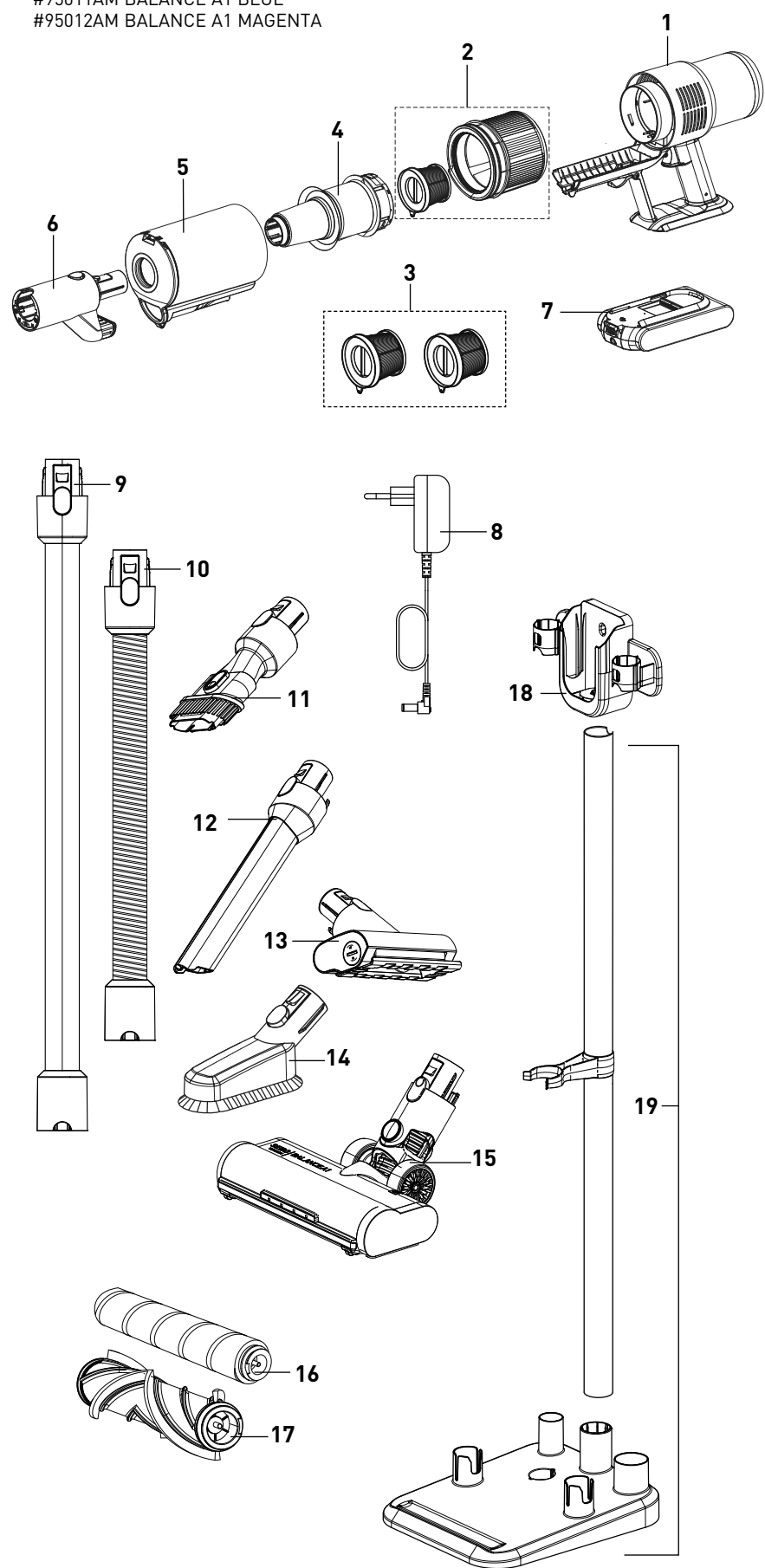

BALANCE A1

#95010AM SEBO BALANCE A1 GRAY Machine

Pos.	Part #	Description
1	95025GA	Suction unit BALANCE A1 GRAY
2	8851AM	Filter set: 1 motor protection filter, 1 micro hygiene filter
3	8850AM	Filter set: 2 Motor protection filters
4	8820AM	Cyclone unit
5	8801AM	Dust container with lid
6	8860AM	Adapter
7	95020SE	Battery
8	95021AM	Charger 120V, 60 Hz, AM-plug 2-wire
9	8831AM	Suction tube
10	8830AM	Extension hose
11	8832AM	Dusting & upholstery nozzle
12	8862AM	LED-Crevice nozzle
13	95031AM	Mini power brush
14	8833AM	Dusting brush
15	95030AM	Power brush
16	8802AM	Bearing block, RH, power brush
17	8816AM	Brush roller MicroCare
18	8815AM	Brush roller MultiCare
19	8870AM	Wall mount
	8871AM	Station B.A1

#95011AM SEBO BALANCE A1 BLUE Machine Exceptions

1	95025BA	Suction unit BALANCE A1 BLUE
---	---------	------------------------------

#95012AM SEBO BALANCE A1 MAGENTA Machine Exceptions

1	95025MA	Suction unit BALANCE A1 MAGENTA
---	---------	---------------------------------