



MADE IN GERMANY

SEBO SOFTCASE CE12
LIGHTWEIGHT

OWNER'S MANUAL

For Household Use Only

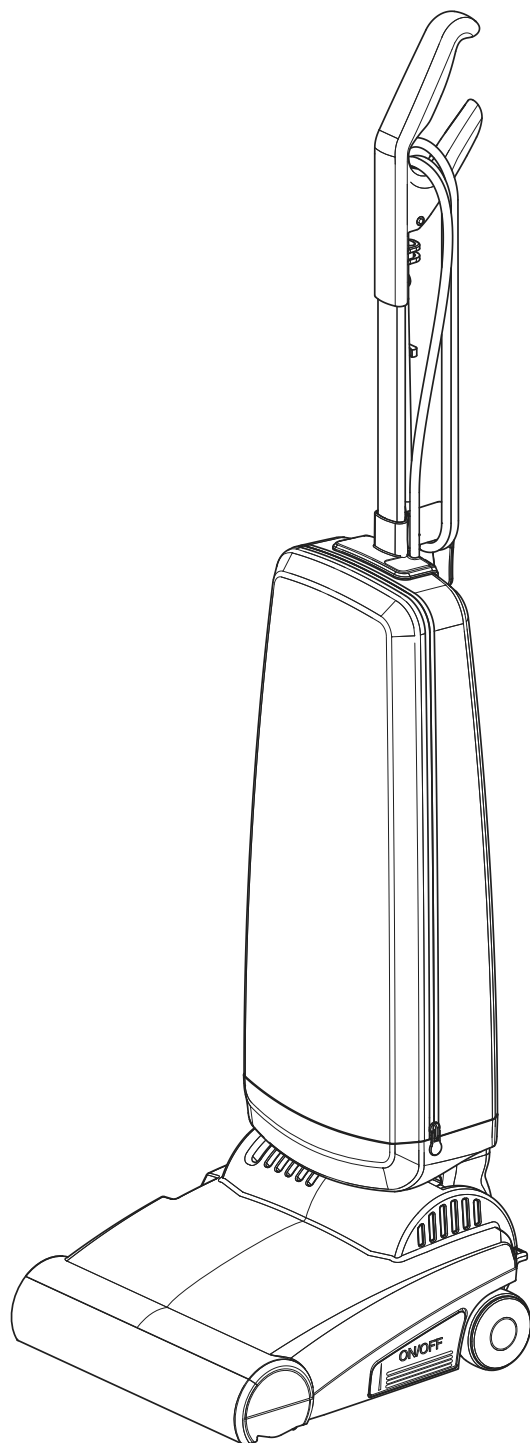

TABLE OF CONTENTS

Technical Details	2
Wiring Diagram	2
How To Contact SEBO	2
Important Safety Instructions	3
SEBO SOFTCASE CE12 Lightweight Features	4
Standard Features of all SEBO Vacuums	4
SEBO's Filtration System	4
Identification of Parts	5
Assembly	5
Operating Instructions	7
Starting the Machine	7
Operating Positions	7
The Height Adjustment Wheel	7
Maintenance	8
Changing the Filter Bag	8
Changing the Brush Roller	8
Clog Removal	9
Clogs in the Airflow Pathway	9
Clogs in Entrance to Filter Bag	9
Clogs in the Bag Housing Air Channel	9
Trouble-shooting Guide	10
SOFTCASE CE12 Lightweight Bag Housing and Handle Schematic and Part Numbers	11
SOFTCASE CE12 Lightweight Power Head Schematic and Part Numbers	12

TECHNICAL DETAILS

Voltage	120 volt
Amperage	4.1 amp
Air volume	7.13 gal/s / 27.1 l/s
Airflow	57 CFM
Water lift	19 in H ₂ O
Filter bag capacity	1.45 gal / 5.5 l
Weight without cord	12.8 lb / 5.8 kg
Weight with cord	15.4 lb / 7 kg
Power head width	12.2 in / 31 cm
Power head clearance	6 in / 15.2 cm
Brush height adjustment	4 levels
Cord length	30.24 ft / 9.25 m
Machine Height	45.6 in / 115.8 cm
Brush drive	Toothed belt
Brush speed	2800-3200 rpm
Impeller speed	17000 rpm

WIRING DIAGRAM

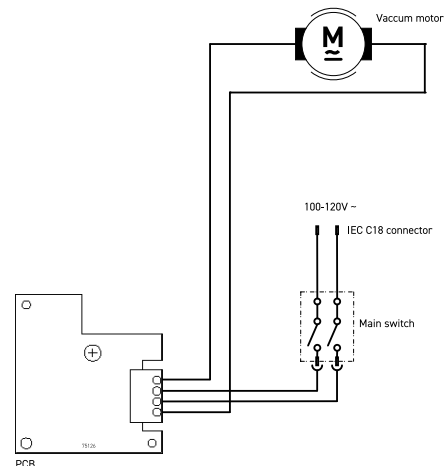

HOW TO CONTACT SEBO

To contact SEBO in the United States of America:

SEBO America, LLC
 Telephone: (800) 334-6614
 Fax: (303) 792-9196
 Website: www.sebo.us

**For warranty coverage details please refer to your
 Warranty Card included with your SEBO vacuum cleaner.**

To contact SEBO in Canada:

SEBO Canada
 Telephone: (877) 258-5005
 Fax: (800) 270-4807
 Website: www.sebocanada.ca

**For warranty coverage details and to register your
 SEBO vacuum cleaner, go to www.sebocanada.ca**

IMPORTANT SAFETY INSTRUCTIONS



READ ALL INSTRUCTIONS BEFORE USING THIS MACHINE

When using an electrical appliance, basic precautions must always be followed.

To reduce the risk of electric shock, this vacuum cleaner has a polarized plug; one blade is wider than the other. This plug will fit in a polarized outlet only one way. If the plug does not fit fully in the outlet, reverse the plug. If it still does not fit, contact a qualified electrician to install the proper outlet. Do not change the plug in any way. Connect only to the outlet type specified on the serial number plate underneath the machine.

SAVE THESE INSTRUCTIONS.

WARNING: To reduce the risk of fire, electric shock, or injury:

1. Do not leave vacuum while plugged in. Unplug from outlet when not in use and before servicing.
2. Do not use outdoors or on wet surfaces.
3. Do not use near small children or pets. Do not allow to be used as a toy. Use of this product by children should always be supervised by an adult.
4. Use only as described in this manual. Use only manufacturer-recommended attachments.
5. Do not use with a damaged cord or plug. If vacuum is not working as it should, has been dropped, damaged, left outdoors, or dropped into water, take it to a SEBO service center.
6. Do not pull or carry by cord, use cord as a handle, close a door on cord, or pull cord around sharp edges or corners. Do not run vacuum over cord. Keep vacuum cleaner and cord away from heated surfaces.
7. Do not unplug by pulling on cord. To unplug, grasp the plug – not the cord.
8. Do not plug in if switch is in the “I” (ON) position.
9. Do not use outlets above counters to plug in vacuum – damage to items in the surrounding area could occur.
10. Always carry the vacuum over steps and sills.
11. Do not handle plug or vacuum handle with wet hands.
12. Do not put any object into vacuum openings. Do not use machine with any openings blocked. Keep openings free of lint, hair, and anything that may reduce air flow.
13. Do not re-use filter bags or wash the filters.
14. Do not remove any screws from vacuum.
15. Do not vacuum up anything that is burning or smoking, such as cigarettes, matches, or hot ashes.
16. Do not use vacuum without filter bag and/or filters in place.
17. Turn off all machine controls before unplugging.
18. Use extra care when cleaning on stairs.
19. Do not use machine to vacuum up flammable or combustible liquids such as gasoline or use in areas where they may be present.
20. Machines can cause a fire when operated near flammable vapors or materials. Do not operate this vacuum near flammable fluids, dust or vapors.
21. Maintenance and repairs must be done by qualified personnel.
22. Use only original SEBO replacement parts.
23. Do not use vacuum as a step.
24. If vacuum is used on plush carpet or carpet with thick padding, do not leave machine standing in one place with machine turned on.
25. Keep hair, loose clothing, fingers, and all parts of body away from vacuum openings and moving parts. Do not place fingers or other body parts under vacuum unless it is unplugged.
26. Do not place the power head over rug or carpet edges.
27. Store the vacuum in a dry place at room temperature. When the vacuum is not in use, you should wrap the cord on the cable hooks.
28. Any other servicing should be performed by an authorized service representative.
29. Always turn off this appliance before connecting or disconnecting power head with brush.

SEBO SOFTCASE CE12 LIGHTWEIGHT PRODUCT FEATURES

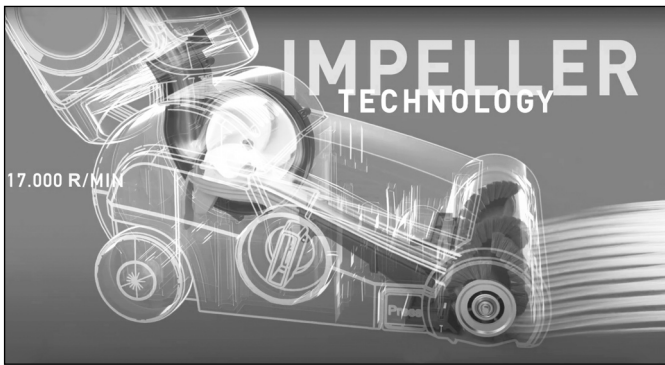

Impeller Technology - The impeller, with up to 17,000 rotations per minute, is driven by a toothed belt. The impeller sucks in the dirt picked up by the rotating brush and transports it through the air channel into the removable filter bag. A simple and effective system, it generates an astonishing volume flow of 7.13 gallons per second despite the relatively low rated power of 400 watts!

Designed for All Floor Surfaces: Four-level Manual Brush Height Adjustment - The brush height can be manually adjusted up or down for optimal cleaning effectiveness. And, to protect flooring surfaces, the brush will raise off the floor when the handle is in the upright locked position.

Easy Brush Roller Removal - Quick brush cleaning or replacement is easy, and no tools are required!

Thirty-foot Cord - A 30-foot cord saves time because it minimizes the number of electrical outlets needed during use.

Automatic Shut-off - In case of a blockage or overload, the vacuum switches off automatically.

Durable Heavy-duty Belts - The reinforced toothed belts do not slip or stretch, resulting in a more efficient use of power, and they should last the life of the machine.

A Flat-to-the-floor, 6-inch Profile - Such a low profile makes cleaning under furniture and beds easy!

Multi-layer Microfilter Bag with Extra-large Volume - The four-layer electrostatic filter bag has a high rate of microfiltration and has an amazing volume of 1.45 gallons - a lot of dust fits in there.

Filter Bag Housing Made of Lightweight, Textile Material - The filter case of the SEBO SOFTCASE CE12 is made from a soft textile material with a 2-way-zip. This lightweight, durable material is shockproof and easy to move by hand.

STANDARD FEATURES OF ALL SEBO VACUUMS:

Designed and Manufactured in Germany - Legendary quality, reliability and performance make SEBO vacuums the first choice of cleaning professionals throughout the world.

World's Best Pet Vacuums - Because of superior power-head and brush-roller technology, SEBO vacuums are the world's best for pet hair removal.

Reliable, Commercial-grade Components - All SEBO vacuums are constructed with thick, reinforced, ABS plastic, aluminum and metal parts, steel axles and bearings, and high-end, quality motors. Therefore, SEBO users own reliable, long-lasting vacuum cleaners. Competing vacuums are made with thin, flimsy, inexpensive, plastic materials, none of which are reinforced, and typically have useful lifespans of one or two years.

Rubber Wheels and Soft Bumpers Protect Homes - Smooth-gliding, rubber wheels protect hard floors and provide exceptional maneuverability. In addition, the bumper that surrounds the power head protects furniture, walls, and the vacuum housing from incurring scuffs and scratches during use.

Advanced, Brush-Roller Technology - SEBO's brush rollers are uniquely designed to funnel hair and debris into the power head's airflow channel, which improves vacuum cleaning performance on all flooring surfaces.

Changing Bags is Easy and Clean - SEBO filter bags can be changed in just a few seconds, and a hygiene cap keeps dust sealed inside during removal and disposal.

Save Money! SEBO Vacuums Last for Years and Extend Carpet Life! - If properly maintained, SEBO vacuums save ordinary, residential users hundreds of dollars, by providing excellent performance for ten to fifteen years or more, and their deep-cleaning, power-brush technology extends the life of carpets. Typical vacuums perform poorly, even when new, and usually do not last beyond two years. So six or seven "disposable vacuums" must be purchased during the average life expectancy of just one SEBO machine.

SEBO's FILTRATION SYSTEM:

Bagged vs. Bagless . . . Bags are Better! - Top-fill filter bags are an integral part of SEBO's filtration system because they hold virtually all the dirt captured by the vacuum. They also ensure continuously strong suction because dirt enters from the top, deposits at the bottom, accumulates upward, and air exits through the sides, which allows unimpeded airflow as they fill to capacity. And they can be tightly sealed with a hygiene cap when full, so no dust can escape into the air during bag removal and disposal.

In contrast, without bags to hold nearly all the captured dirt, the microfilters on bagless vacuums quickly clog from excessive dirt build-up and must be replaced often, or a loss of suction and cleaning effectiveness will occur. In addition, dust becomes airborne when emptying bagless dirt containers. Lastly, bagless vacuum microfilters are expensive, usually costing more than a multi-year supply of SEBO filter bags.

IDENTIFICATION OF PARTS

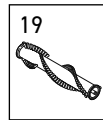
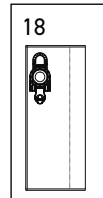
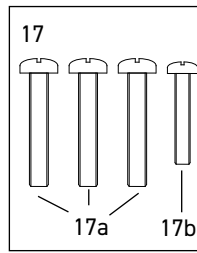
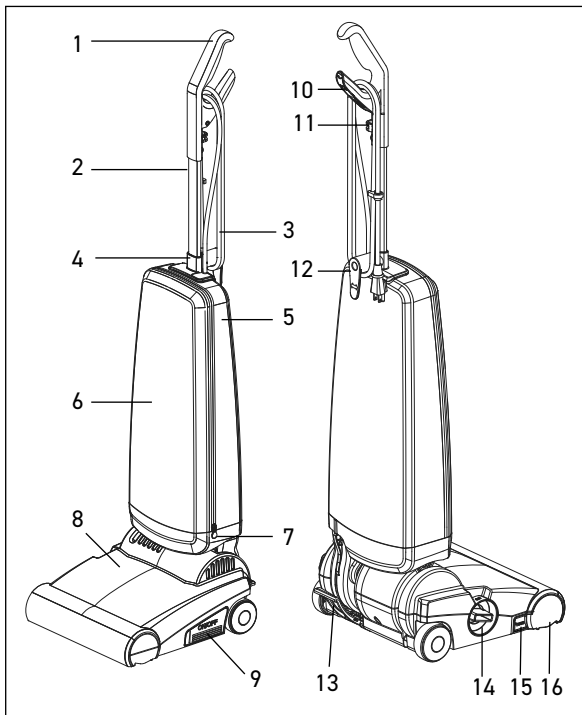

1. Handle grip
2. Handle tube
3. Cable (cord)
4. Handle guide
5. Bag housing
6. Front cover
7. Cover release zipper
8. Power head
9. On/Off switch
10. Strain relief catch
11. Cable guide for mains cable
12. Cable (cord) rotating hook
13. Foot pedal
14. Pile adjustment knob
15. Brush release button
16. Side plate for brush housing
17. Screw set: 17a (3) M5x30, 17b (1) M4x10
18. Filter bag
19. Brush roller

ASSEMBLY

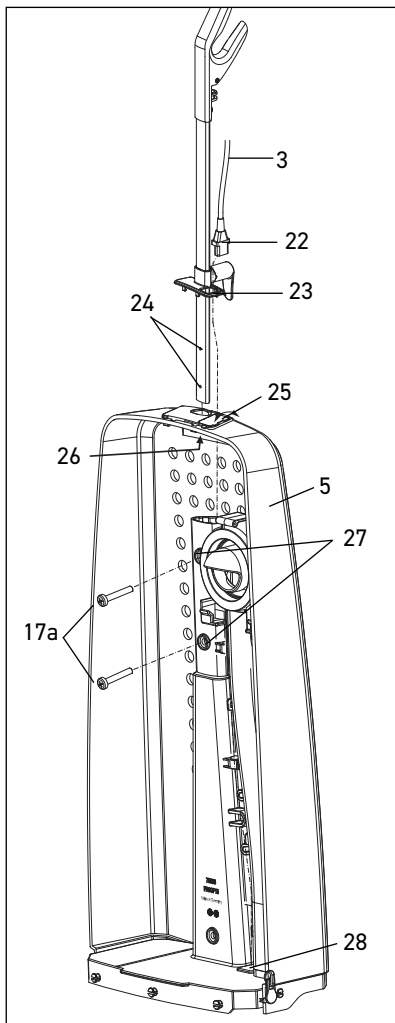

Figure 2

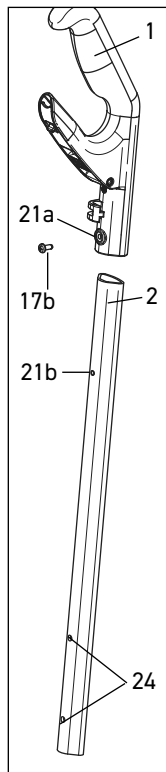
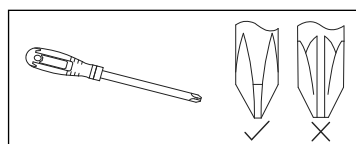

Figure 1

Step 1 (figure 1): Insert the handle grip (1) into the handle tube (2). Slide it down until the screw hole in the handle (21a) lines up with the screw hole in the handle tube (21b). Secure with the M4x10 screw (17b) using a phillips-head screwdriver (not included).

Step 2 (figures 1 & 2): Unzip the front cover of the bag housing (5) completely. **Note: The bag housing cover cannot be removed completely! It has been omitted in the illustrations to improve clarity.** Open the flap (25) in the base of the shaft guide. This flap can be unlocked with the latch (26) from inner side of the filter housing. Guide the power cable (3) through the upper part of the shaft guide (23) as indicated by the dash-dot line. Loosely route the cable plug (22) to the bottom of the filter housing (28).

Insert the handle assembly into the lower shaft guide and slide it down until the screw holes in the handle tube (24) line up with the lower screw holes (27), and attach using 2 M5x30 screws (17a) from the screw set. Use a phillips-head screwdriver (not included).



Use a phillips-head screwdriver to affix all included screws, not a flat-head screwdriver. Screwdriver is not included.

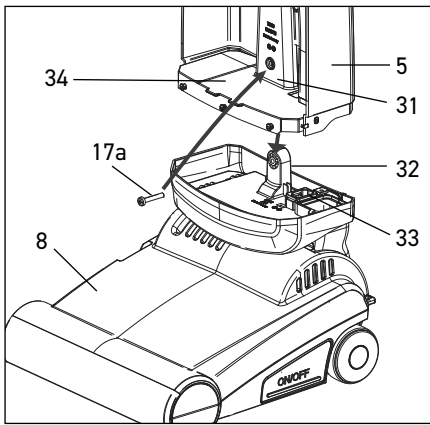

Figure 3

Step 3 (figure 3): Place the power head (8) on the floor. Place the bag housing (5) on the power head so that the connecting piece on the power head (32) fits into the corresponding opening in the bottom of the bag housing (31). Unzip the front cover of the bag housing completely. Press down on the bottom of the bag housing (34) with the flat of your hand and gently push into place. Alternately, use the handle assembly to align the upper and lower parts of the machine. When both parts fit correctly, secure the connection of the connecting piece (32) and the opening in the bag housing (31) with the remaining M5x30 screw (17a) from the screw set. Use a phillips-head screwdriver (not included). Adjust the ends of the zipper to fit into the bottom part of the housing. **Note: The bag housing cover cannot be removed completely! It has been omitted in the illustrations to improve clarity.**

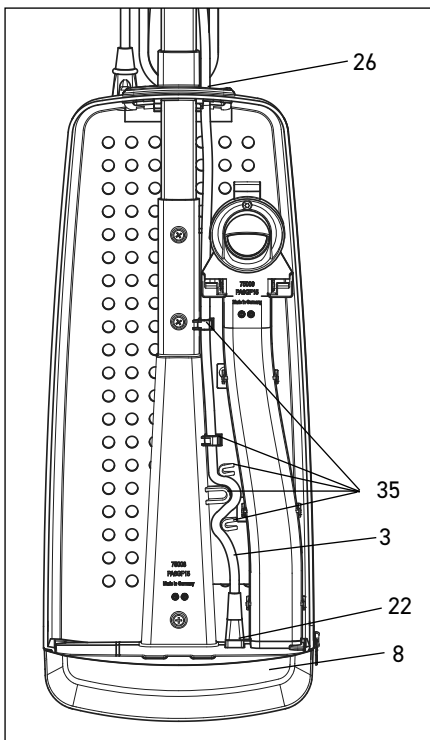

Figure 4

Step 4 (figure 4): Plug the cable plug (22) into the outlet in the power head (#33, figure 3). Route the cable as shown from bottom to top using fixing points (35). All remaining cable length will then move to the top through the shaft guide. Close the shaft guide flap (26). Continue threading the cable up into the strain relief (see step 5). **Note: The bag housing cover cannot be removed completely! It has been omitted in the illustrations to improve clarity.**

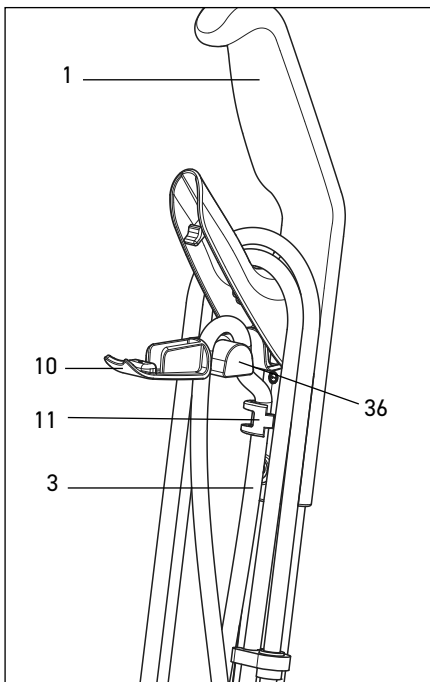

Figure 5

Step 5 (figure 5): Open the strain relief catch (10) in the handle grip (1). Insert the cable (3) into cable guide (11) and the strain relief (36), looping as shown, with some slack toward the machine. When closing the strain relief catch, the additional length distributes itself automatically or can be reduced by pulling gently.

Step 6: Install the filter bag (see page 8 for detailed instructions).

OPERATING INSTRUCTIONS

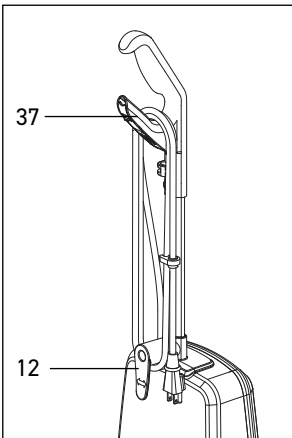

Figure 6

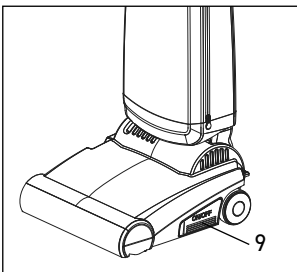

Figure 7

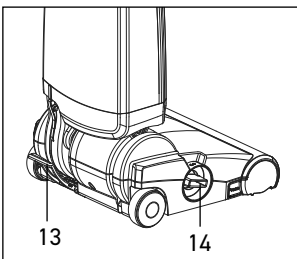

Figure 8

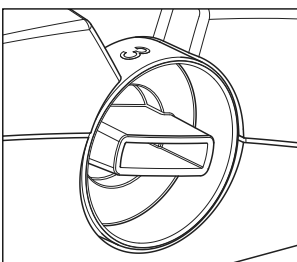

Figure 10

Starting The Machine - Figures 6 & 7

Before turning on your vacuum cleaner, make sure that the vacuum handle is in its upright locked position and that you have a firm hold on the handle grip to keep the machine from moving forward.

1. Turn the quick release cable hook (12) to the up position by moving it to the left or right (figure 5).
2. Release the power cord plug from the cord and lift the cord off of the upper cord hook (37) on the handle grip.
3. With the on/off button (9) in the OFF position (figure 7), plug the polarized power cord into a 120 volt outlet located near the floor.
4. Gently push the on/off button (9) with your foot or hand to turn it on. Gently push again to turn it off.

Operating Positions - Figures 8 & 9

To release the machine from the upright locked position, press down on the foot pedal (13) and lower the handle into the normal operating position. The handle can be lowered to a horizontal position useful for vacuuming under beds (figure 9).

When finished or pausing, the handle must be placed in the upright locked position. Push the handle upward until the foot pedal snaps in place to lock. To protect flooring surfaces, the brush will raise off the floor when the handle is in the upright locked position.

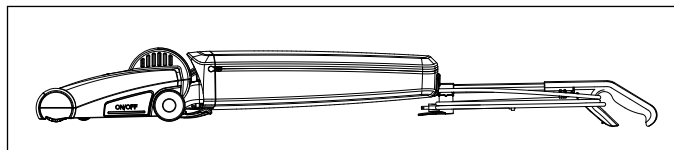

Figure 9

The Pile Adjustment Knob - Figures 8 & 10

The pile adjustment knob (14) has 4 brush height settings. Setting 1 is the lowest brush setting for lower pile carpeting and setting 4 is the highest brush setting for higher pile. When starting the vacuum, always start with the knob set at 4, then lower knob settings until the brush reaches the proper height.

With these settings, the optimal balance between flooring protection, pushing force and brush roller wear can be achieved. If the cleaning performance is not sufficient, even in position 1, the brush roller is worn and needs to be replaced.



WARNING! The quality, condition, coating, texture, age and manufacturing technique of all floor surfaces vary. Therefore, upright vacuums with rotating brushes, including your SEBO, may damage some floor coverings or surfaces. Some types of high-gloss hardwood floors, cushion vinyl, berber carpets, long shag, and delicate or hand-woven carpets are particularly vulnerable to damage by rotating brushes. When possible, consult the materials supplied by your floor's manufacturer for information on proper upkeep and cleaning. **To ensure that your new SEBO vacuum cleaner is compatible with your floor, please test the vacuum cleaner on each type of flooring surface in a small inconspicuous area to determine if any damage occurs. If damage occurs, stop using the vacuum cleaner immediately! Care must be taken to ensure that the bottom of the machine does not contact the floor. If this happens, damage to the floor could occur. If damage occurs, stop using the vacuum cleaner immediately!**

MAINTENANCE



Always unplug vacuum from outlet before dismantling any part of the machine!

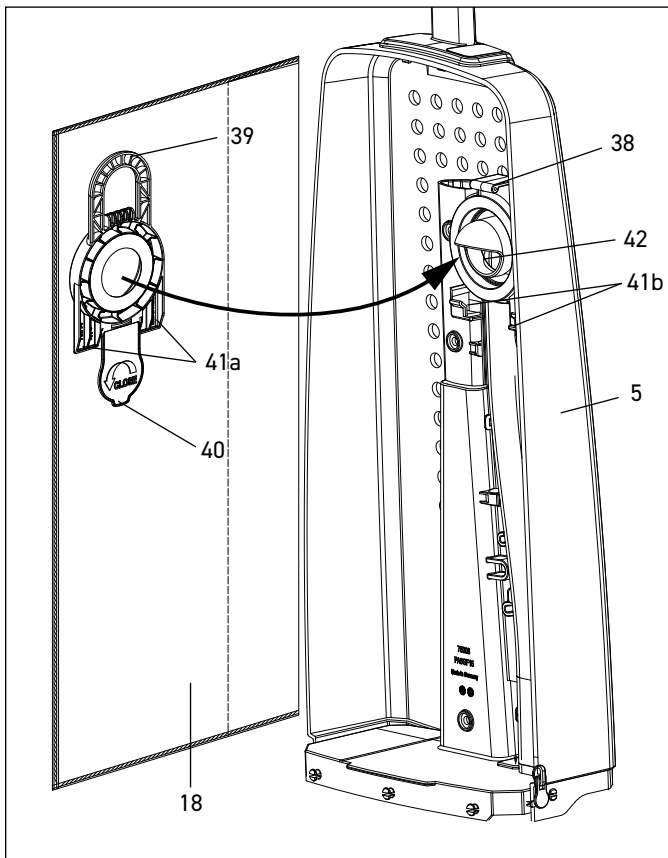

Figure 11

Changing the Filter Bag - Figure 11

Removing the filter bag: Unzip the front cover of the bag housing (5). Lift the latch (38) slightly with your thumb and pull the green handle (39) on the filter bag up and out. Seal the filter bag with the attached lid (40).

Installing the filter bag: Unzip the front cover of the bag housing (5). Insert the tabs (41a) of the filter bag (18) into the grooves (41b) in the vacuum. Tilt it upward until the latch (38) locks in place. The filter bag will be automatically positioned onto the air channel opening (42). Close the front cover (6).

Note: The filter bag should hang smoothly and straight in the unit to ensure maximum suction power and dust collection.

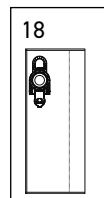

Filter bag pack of 8 x 75150
Part #75175AM

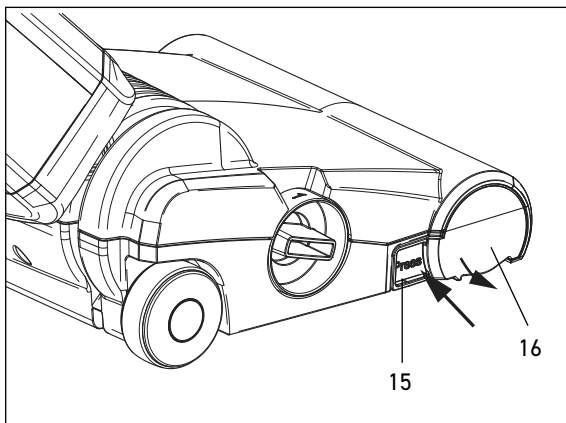
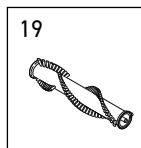

Figure 12

Changing the Brush Roller - Figures 12 & 13

To change the brush roller (19), firmly push the release button (15), rotate the side plate (16) downward and remove it. Turn the brush clockwise a quarter of a turn, and pull the old brush roller out. Slide the new brush roller into the brush housing and turn it until it locks into position. Rotate the side plate (16) upward back into the locked position.

Check the brush roller regularly for coiled yarn or hair and remove them for optimal brush roller action.



Brush roller
Part #5010AM

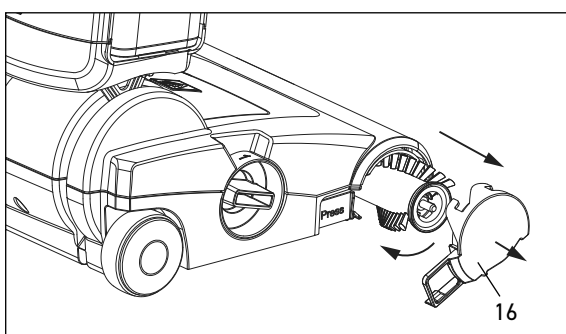

Figure 13

CLOG REMOVAL



Always unplug vacuum from outlet before dismantling any clogs!

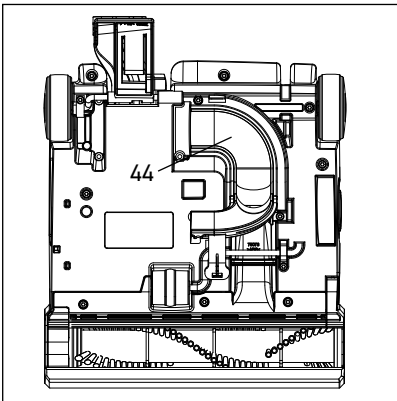

Figure 14

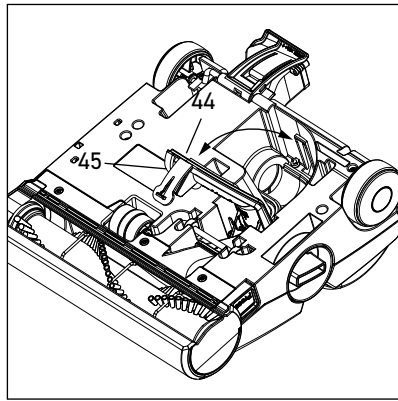

Figure 15

Clogs in the Airflow Pathway - Figures 14 & 15

Most clogs can be removed by accessing the airflow pathway via the orange access door (44) located on the underside of the power head. Push the latch (45) to release the door and swing it open (figure 15). After removing the blockage, swing the access door (44) closed until the latch (45) clicks shut.

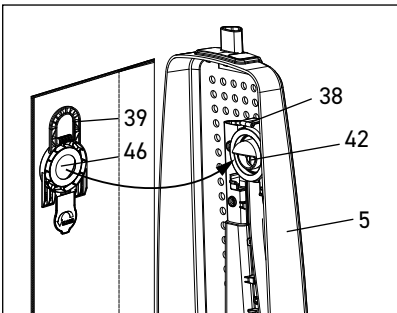

Figure 16

Clogs in Entrance to Filter Bag - Figure 16

Unzip the front cover of the bag housing (5). To remove the filter bag, lift the latch (38) slightly with your thumb and pull the green handle (39) on the filter bag up and out. Clean out air channel opening (42) and/or entrance to bag (46).

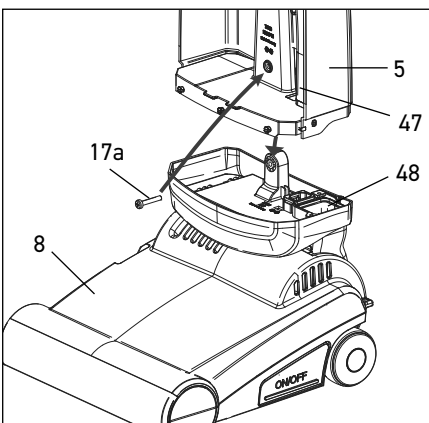

Figure 17

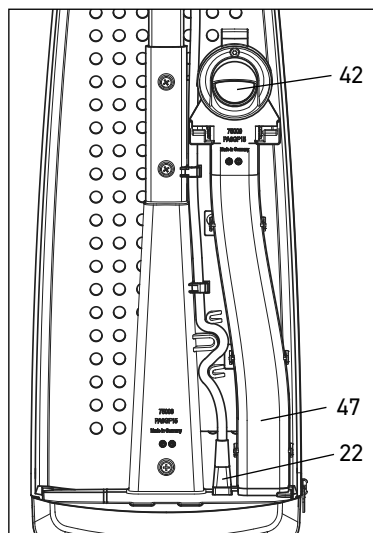

Figure 18

Clogs in the Bag Housing Air Channel - Figures 17 & 18

If you suspect a blockage in the bag housing air channel (47), unzip the front cover of the bag housing and remove the filter bag (see above). Unplug cable plug in machine (22), remove screw (17a) and separate power head (8) and bag housing (5). The air channel (47) in the filter compartment can then be checked from the bottom (48). **Do not try to open the air channel, as this will damage the machine!**

Note: To avoid damaging the machine, never use a stick or other hard object to clear blockages or clogs.

TROUBLE-SHOOTING GUIDE



Always unplug vacuum from outlet before dismantling any part of the machine!

PROBLEM	REASON	SOLUTION
Does not turn on	1. Not plugged into good outlet.	1. Use another outlet.
	2. Cable worn.	2. Replace cable.
	3. Internal plug is unconnected or loose.	3. Re-seat the plug. See page 6, figure 3.
Decreased suction or no suction.	1. Filter bag is full.	1. Replace bag. See page 8.
	2. Clog in airflow pathway, entrance to filter bag or bag housing air channel.	2. See Clog Removal on page 9.
Machine shuts off.	1. Brush roller is blocked.	2. Check bottom of machine and brush roller. See pages 8 and 9.
Poor brush performance.	1. Brush worn.	1. Replace brush. See page 8.
	2. Incorrect brush setting.	2. Adjust the brush by turning the pile adjustment knob up or down.

SOFTCASE CE12 LIGHTWEIGHT

#94251AM SOFTCASE CE12 Lightweight - USA
#94251FC SOFTCASE CE12 Lightweight - Canada

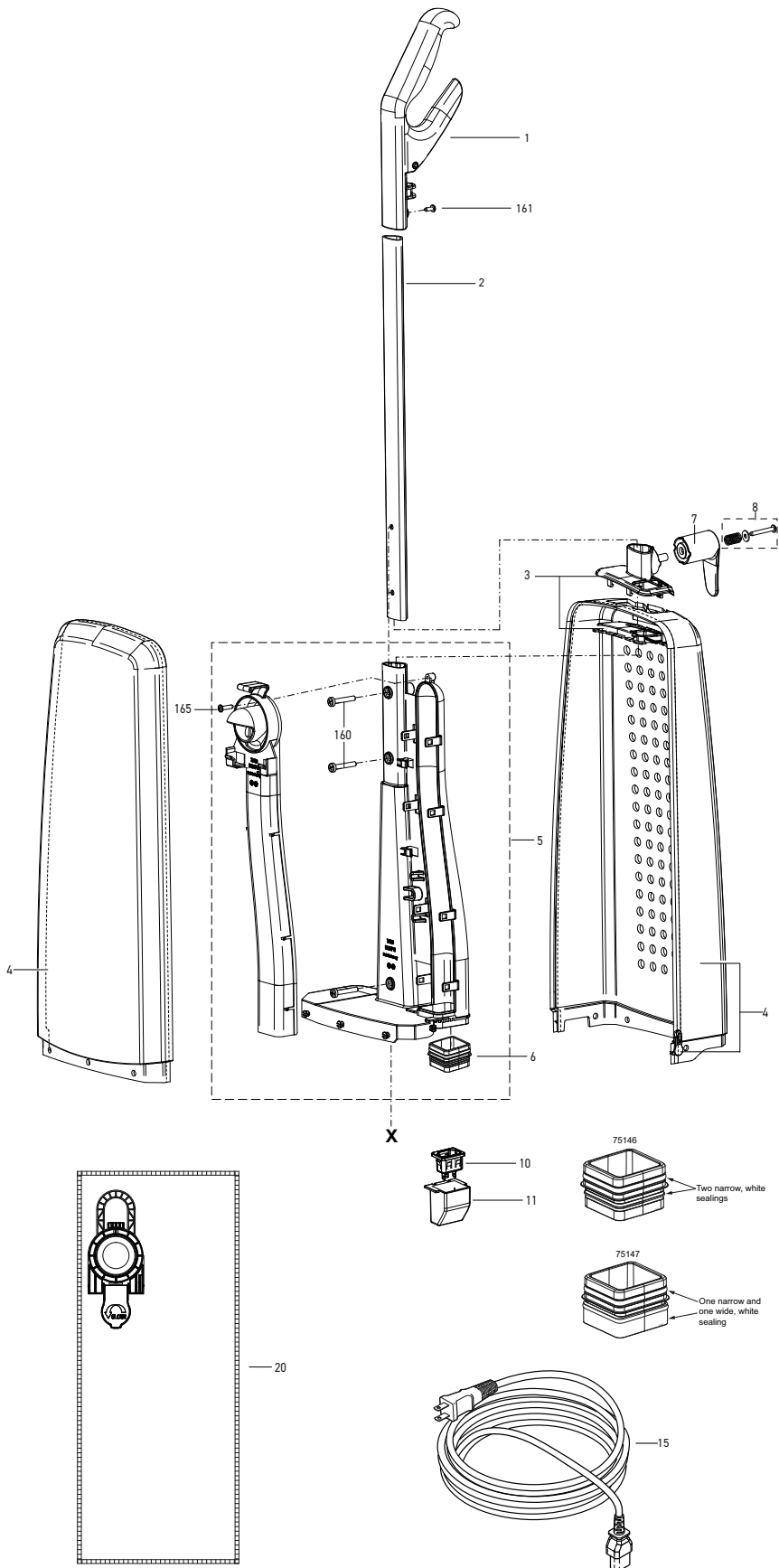

Bag Housing and Handle

#94251AM SOFTCASE CE12 Lightweight - USA
#94251FC SOFTCASE CE12 Lightweight - Canada
Arctic White/Black Machine

Pos.	Part #	Description
1	75103GS	Grip SOFTCASE CE, cpl., gray black
2	75033	Handle rod SOFTCASE CE, 557mm
3	75156GS	Handle guide, 2 pcs., gray black
4	75101	Bag housing, assembled
5	75102ER	Air guide, complete, assembled
6	75146	Sealing adapter, cable
7	75026GS	Cable hook, gray black
8	75158ER	Mounting set cable hook
10	8177ER	Mains connector, 2-wire
11	75032GS	Protection cover
15	75031	Cable, 2-wire, 9,25m 2x17 AWG, US-plug
20	75175AM	Filter bag (8 x 75150)
160	0111	Screw AM5x30, 7985
161	0127	Screw M4x10, DIN 7985
165	01036	AMTEC screw M4x14, TX 20

All screws without item number = 01016

SOFTCASE CE12 LIGHTWEIGHT

#94251AM SOFTCASE CE12 Lightweight - USA
 #94251FC SOFTCASE CE12 Lightweight - Canada

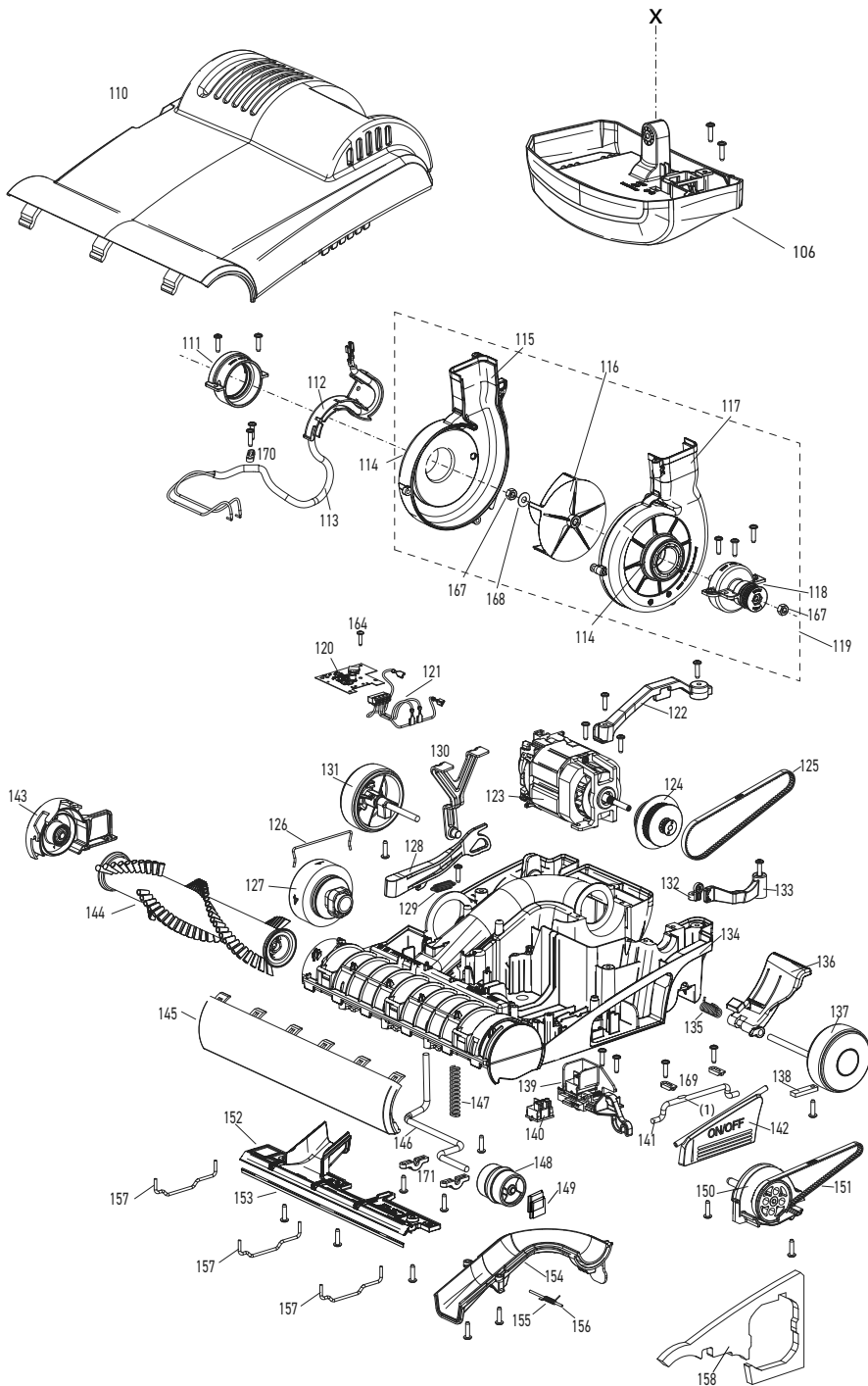

(1) When mounting, marking on this side

Power Head

#94251AM SOFTCASE CE12 Lightweight - USA
 #94251FC SOFTCASE CE12 Lightweight - Canada
 Arctic White/Black Machine

Pos.	Part #	Description
106	75229WESE	Central support, arctic white, assem.
110	75289CEER	Top cover SEBO SOFTCASE CE12, arctic white
111	75129	Swivel neck support, r.h.
112	75066GS	Cable channel
113	75117	Swivel neck cable, 2-wire
114	75067	Swivel neck support bushing
115	75064GS	Blower housing rh, gray black
116	75060HE	Rotor, light ivory
117	75063GS	Blower housing lh, gray black
118	75116	Swivel neck support, l.h., cpl.
119	75138ER	Blower/swivel neck, gray black, assembled
120	75126ER	PCB 120 V~
121	75118	Motor cabling, 2-wire for 2-wire & 3-wire machines
122	75080HG	Motor bridge, light gray
123	75053ER	Motor 120 V~
124	75110ER	Torque sensor, SOFTCASE
125	2923	Toothed belt 333 HTD 3M 6
126	75059	Latching bracket
127	75076OR	Selector brush height
128	75086	Slider height adjustment
129	4019	Spring
130	75122	Support lever
131	75112GS	Wheel w/axle, assembled
132	75096ER	Magnet support, assembled
133	75079ER	Magnet lever, assembled
134	75133SE	Bottom unit
135	75093	Spring foot pedal
136	75062OR	Foot pedal
137	75119GS	Wheel w/axle foot pedal, lh
138	2849	Bracket
139	75124ER	Switching unit, assembled
140	05112ER	Rocker switch
141	75094	Switching rod
142	75061OR	On/Off button
143	75114GS	Bearing block rh
144	5010AM	Brush roller 31 cm
145	75068GS	Bumper SOFTCASE, gray black
146	75095	Pile adjustment axle
147	75090	Spring pile adjustment
148	75121GS	Pile adjustment wheel, assembled
149	5155GS	Rubbing plate
150	75113	Bearing block lh
151	75098	Toothed belt 318 HTD 3M 6
152	75134GS	Rear base plate
153	5400-4	Sealing strip SOFTCASE, 259 mm
154	75120SE	Cover air channel, gray black/orange
155	5304	Spring
156	2910	Bearing pin
157	5402	Wire tie, long
158	75097UL	Air separator
160	0111	Pan head screw AM 5x30 4.8
161	0127	Screw M4 x 10
162	01016	Pan head screw STS 4x16 T20
163	01021	Pan head screw, F 3,9x13
164	01029	Screw C 2,9x13 DIN 7981
165	01036	AMTEC screw M4x14, TX 20
166	01037	Screw 3,0x16, TX 10
167	0262ER	Nut M6, left hand thread
168	0150ER	Washer B 4,3 DIN 9021
169	2494ER	Plastic bracket
170	1030UL	Strain relief
171	75075ER	Axle bracket

All screws without item number = 01016